

Date: 06-04-2024

P#24112

MVWSD
1400 Montecito Ave
Mountain View, CA 94043
rwestover@mvwsd.org

Subject: *Fee Proposal – Topographic Surveying Services
Crittendon Middle School
1701 Rock St, Mountain View, CA 94043*

Dear Ms. Westover:

Underwood & Rosenblum, Inc (U&R) is a full-service Civil Engineering and Land Surveying Firm with over 40 years of service to the Bay Area. This scope of work is only for Land Surveying services.

Client shall provide:

- Complete access to the project area during normal business hours (8am-5pm).

Scope of Work:

Topographic Ground Survey:

U&R shall provide a detailed topographic survey of the area as shown on the attached Exhibit "A". The topographic survey within this area will include the following:

- Spot elevations across the area to approximate a 25-foot grid to include all high and low points, grade breaks and flow lines;
- All surface visible utilities as well as invert and flow line data for existing storm and sanitary sewers. If confirmable from field observation, storm and sanitary lines will be shown connected to their respective utility structures;
- Contours will be provided at 1-foot intervals;
- Existing buildings, finish floors, exterior doorways and roof overhangs;
- Trees over 6" in diameter including driplines;
- Existing fences and walls;
- All hardscape areas including walks, curbs, driveways, concrete structures, pavement and other areas of improvement;
- Parking lot striping, paint and signage, speed bumps, wheel stops, and curb paint;
- Playground striping and paint;
- Vertical datum tied to a city benchmark.

Topographic Survey Fee \$9,500.00

Total Survey Fee \$9,500.00

Deliverables:

- A digitally signed and stamped plat of the topographic survey delivered by email.
- A copy of the Digital CAD files delivered by email.

Some items not included in this proposal:

- Clearing/removal of overgrown vegetation, hazardous plants, materials, or insects.
- Surveying beyond the limits described above.
- Resolution of boundary disputes with neighbors.
- Creation of any document to be recorded and/or filed with any agency.
- Creation and recording of a Record of Survey, easements or legal descriptions.
- Permanent monumentation of property.
- Construction staking.
- Boundary Surveying.
- Underground Utility Scoping.
- Meeting attendance.
- Engineering or design services.

Work requested beyond the Scope of Work defined above shall be considered "Extra Work" and will not be performed without your prior authorization and agreement to the additional fees. Client shall pay for reasonable charges on written change orders from U&R for services, modifications or additions to this agreement.

Notwithstanding any other provision herein, to the fullest extent permitted by law, Client under this Contract Agreement expressly agrees to limit the liability of Surveyor, whether arising from tort, contract or otherwise, for any and all actual or alleged loss arising from professional errors and omissions to an amount not to exceed this Contract Agreement fee. Client further agrees to limit any other claim(s) of any kind whatsoever of Client against U&R to an amount not to exceed this Contract Agreement fee. U&R's services will be conducted within the limits prescribed by this agreement. In a manner consistent with that level of care and skill ordinarily exercised by members of the same profession currently practicing in the same locality under similar conditions. No guarantee, warranty or representation, express or implied, is included or intended herein.

Neither party shall be held liable for failure or delay in the performance of its obligations under this Contract, if such performance is delayed or hindered by the occurrence of an unforeseeable act or event which is beyond the reasonable control of either party ("Force Majeure Events"). Acts or events constituting Force Majeure Events shall include, but not limited to Act of God, government intervention, directives or policies. The party affected by a Force Majeure Event shall notify the other as soon as soon as reasonably practicable after commencement of a Force Majeure Event.

This agreement may be terminated by either party upon not less than seven days written notice should the other party fail substantially to perform the duties outlined in this agreement through no fault of the party initiating the termination. All fees, payments and reimbursements for services performed due U&R whether invoiced or not shall be satisfied in full prior to termination of this agreement. We shall bill for the full amount of the fee upon completion of the survey work. Unpaid billings over thirty (30) days from the date of billing are considered delinquent and are subject to a monthly charge of

Date: 06-05-2024
Crittendon MS, Mountain View CA
Page 3 of 5

0.833%. Please sign and date the authorization below as your acceptance to this proposal and return one copy to our office.

Sincerely,

UNDERWOOD & ROSENBLUM, INC.



Frank M. Rosenblum, PLS 6395, PE 42857
Principal Land Surveyor & Engineer/President

Attachments: Exhibit "A" – Limit of Topographic Survey
Exhibit "B" - Current Billing Rates

AUTHORIZATION TO PROCEED:

Signature Title

Print Name Date

** Please provide WHO we are billing for these services**

BILL TO:

Company Name

Attn to: Individual Name

Email Address

Exhibit "A"
Limit of Topographic Survey

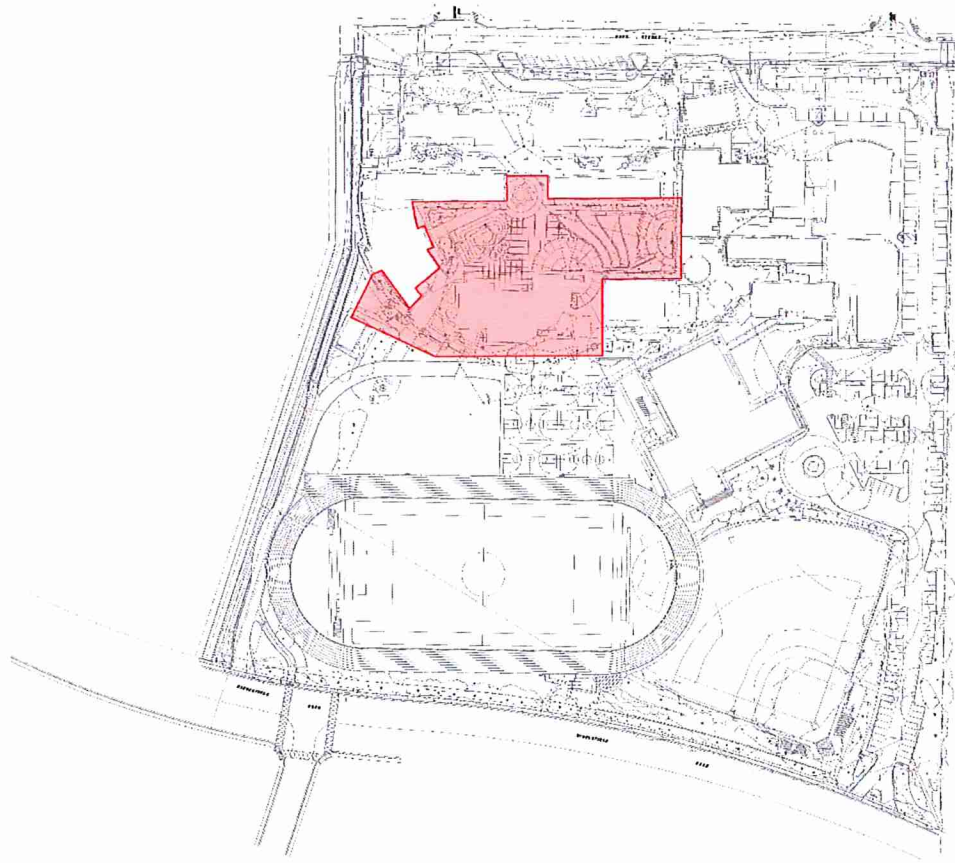

Exhibit "B"
UNDERWOOD & ROSENBLUM, INC.
2024 BILLING RATES

SERVICE	HOURLY RATE
Principal E ngineer	\$ 265.00
Principal L and S urveyor	265.00
Senior E ngineer	230.00
Associate E ngineer/ A ssoc. L and S urveyor	200.00
Assistant E ngineer/ S urveyor	170.00
Engineering/ S urveying T echnician	150.00
Senior D rafter- E ngineering	135.00
Senior D rafter- S urveying	135.00
D rafter- E ngineering	125.00
D rafter- S urveying	125.00
T echnician	115.00
Administrative A ssistant	105.00
1 -Person F ield S urvey	280.00
1 -Person F ield S urvey Prevailing Wage	310.00
2 -Person F ield S urvey Crew	410.00
2 -Person F ield S urvey Prevailing Wage	470.00
3 -Person F ield S urvey Crew	540.00
3 -Person F ield S urvey Prevailing Wage	630.00
Expert W itness Testimony	400.00
Other Reimbursable Expenses	
- Automobile	\$0.65 per mile
- Blueprints, Reproductions, Deliveries Maps, Deeds, Documents, etc.	Cost + 10%
- Title Reports	Cost + 35%