

Monta Loma Summary for Schematic Design

The Monta Loma perimeter control project has been a three-year process that has resulted in the schematic design that is being presented for approval by the Board tonight. As part of Measure T and the [Master Facility Plan](#) approved on December 12, 2019, perimeter controls were planned at every school site as part of the “safety” items prioritized in the [Master Facility Plan](#).

INCLUDED IN MEASURE T

BENEFITTING ALL SCHOOLS

- **Affordable staff housing**
 - Ensures our high-quality teachers and staff can stay in MVWSD
- Vargas Elementary and District Office **construction costs repayment** (certificates of participation)
 - Reduces reliance on lease revenue to free funding for long-term growth solutions

Bond prioritizes:

- **Staff housing**
- **Construction repayment frees up funding for other school projects**



WHAT EACH SCHOOL GETS (3-5 YEARS)

School	Projects
Bubb	Window, Green, Lock, Sun, Lightbulb
Castro	Lock, Sun, Tent, Classroom, People, Parking
Crittenden	Lock, Sun, Tent, Lightning
Graham	Window, Green, Lock, Sun, Tent
Huff	Window, Green, Lock, Sun, Tent, Lightbulb, People, House
Landels	Window, Green, Lock, Sun, Tent, Lightbulb, People, House
Mistral	Window, Green, Lock, Sun, Tent, People
Montal Loma	Window, Green, Lock, Sun, Tent, Water
Stevenson	Lock, Sun, Tent, Classroom, Plant
Theuerkauf	Window, Green, Lock, Sun, Tent, Lightning, Water
Vargas	Sun, Tent, Classroom, Plant

PROJECTS TOUCH EACH SCHOOL

Safety

- Perimeter controls to monitor access onto campuses during school hours
- Improved site lighting in parking, playground and other areas
- Separate adult restrooms at playfields
- Add storage, removing hazards

Operational Efficiency

- Replace aging mechanical HVAC systems
- Replace windows with high-performing glass.
- Add shade structures
- Add solar arrays to offset electrical costs
- Add landscaping to reduce heat islands
- Repair site plumbing lines
- Upgrade electrical

Short-Term Growth

- Adding space to Landels and Huff, where the most short-term growth is predicted

1400 Montecito Ave., Mountain View, CA * www.mvwsd.org/facilities

At Monta Loma, school staff and parents regularly needed to request that members of the public not enter the campus during school hours. There were incidents in which staff needed to call MVPD to escort individuals off campus thus necessitating a solution. The initial

plan presented to the community was not seen favorably, and there was confusion from the Monta Loma neighborhood about who owned the land. Many residents viewed the school field as a public park.

The [Monta Loma Work Group](#) was formed and met from February 25 through May 27, 2021. The work group was composed of community members, teachers/staff, City representatives, and parents.

The Monta Loma working group's task was to make sure MVWSD heard all of the considerations regarding the shared use of the campus and build consensus around a solution that would work for stakeholder groups. The working group was composed of a total of 9 members.

Goals:

- Respond to the District's Master Facilities Plan to create a feeling of safety on the Monta Loma Campus
- Share perspectives regarding the school and the open space
- Understand and balance needs and to collaborate on a successful solution to all of the issues
- Maintain open and equitable access to park and open space
- Maintain the community
- Provide a safe space for students and staff

The Monta Loma Working Group gathered valuable information on how the open space was used but could not find a consensus on what was needed on the field.

A [pilot program](#) began in the summer of 2021 based on some of the feedback received from the Monta Loma Working Group. It consisted of signage and cones that delineated the spaces and times that the public could be in the area. The program was not successful because members of the public did not see or follow the signage.

Dates and Hours: The pilot program is scheduled to start when summer school begins on June 14, 2021 and will continue through July 9, 2021 when summer school ends. During summer school, public access will be limited to the designated areas during the school hours of 7:30am to 4:00pm. Outside of school hours, the public will have full access to the fields.

The diagram below shows where signage will be located and illustrates areas accessible to the public.

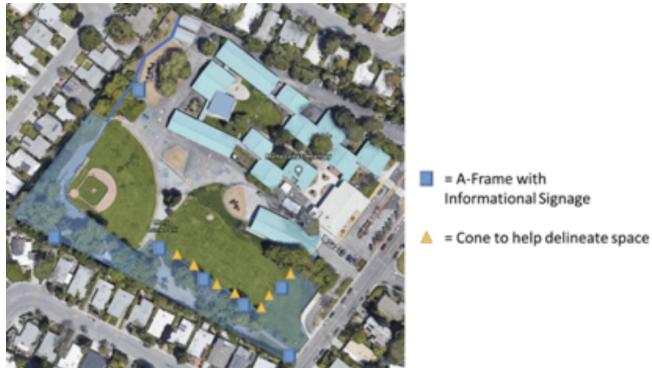

On June 17, 2021, the Board gave direction to move the Monta Loma open space reconfigurations to a priority 1 project in the [Master Facilities Plan](#) and bring on an architect. Carducci Associates was selected to perform a series of input meetings with stakeholders and produce solutions for the field configuration that benefit all users. Carducci led more than 20 input and focus group meetings with the community.

Focus Group Input Sessions

City Staff focus group - Tuesday, January 4, 2022

School focus group - January 5, 2022

City Recreation Leagues focus group - Thursday, January 6, 2022

Seniors focus group - Wednesday, January 19

Families focus group - Thursday, January 20, 2022

Neighborhood focus group - Wednesday, January 26, 2022

Community Input Meetings

MVWSD Board of Trustees Meeting - Public - Thursday, December 9, 2021.

Community input process - Public - Wednesday, December 15, 2021

Community input meeting A - Public - Thursday, January 27, 2022

Community Meeting A - Saturday, January 29, 2022

MVWSD Board of Trustees Meeting - Public - Thursday, February 10, 2022.

Community meeting B - Wednesday, February 16, 2022

Community meeting B - Saturday, February 19, 2022

City Council Update - Public - Tuesday, March 8, 2022

Community meeting C - Wednesday, March 9, 2022

Community meeting C - Saturday, March 12, 2022

MVWSD Board of Trustees Meeting - Public - Thursday, March 24, 2022

Community meeting D - Wednesday, April 6, 2022

MVWSD Board of Trustees Meeting - Public - Thursday, May 5, 2022.

Community meeting-August 24, 2023, in the Monta Loma Elementary Multi-use room

Monta Loma Ice Cream Social - August 27, 2023

Board of Trustees special meeting -August 28, 2023

Communication to community members was sent via mailed postcards, updates on the district's website, emailed updates and reminders, online surveys, social media, the community board, and A Frame signs on the field.

Example of postcard



Lessons learned from the community meetings included an awareness that MVWSD provides much of the open space available to Mountain View residents. MVWSD has approximately 57 acres that are evenly distributed around the city.



In August, the District held a series of community meetings to discuss three possible options the Board of Trustees would consider.

August 24, 2023 - Community meeting in the Monta Loma Elementary Multi-use room

August 27, 2023 - Monta Loma Ice Cream Social

August 28, 2023 - Board of Trustees special meeting

On September 7, 2023, the Board of Trustees approved [option one](#) as a conceptual design for fencing with the goal of balancing school field use and community access during the day.

After the Board gave guidance on September 7, 2023, Carducci worked to create a schematic design. The district then held a series of meetings to answer questions and ask for any considerations that may have been missed.

February 12, 2024 - School Site Council

February 13, 2024 - English Language Advisory Committee & PTA Executive Board

February 28, 2024 - Staff Meeting

March 1, 2024 - Principal Pop-In Hour

February 27, 2024-Community Meeting

The feedback from the meetings was generally positive and community members and staff were happy to be able to move forward with a plan. During the community meeting, residents felt that the design was a good compromise and they felt that they had been heard. One resident stated that a ten-foot fence or higher would be preferable for security but other residents did not agree and wanted to keep the proposed fence height. One resident requested that all decorative iron fencing be used as opposed to the chain link for security.

The City of Mountain View was also invited to share feedback. The City requested that the fencing be moved closer to the pathway near the right and left field line of the baseball diamond (shown in red). Additionally they requested that the fence line near the soccer field be moved further into the grass to square off the end of the soccer field to align with the adjacent pathway and to align fencing with existing sprinkler lines.

Suggestions from the City of Mountain View Parks and Rec Dept, February, 20, 2024

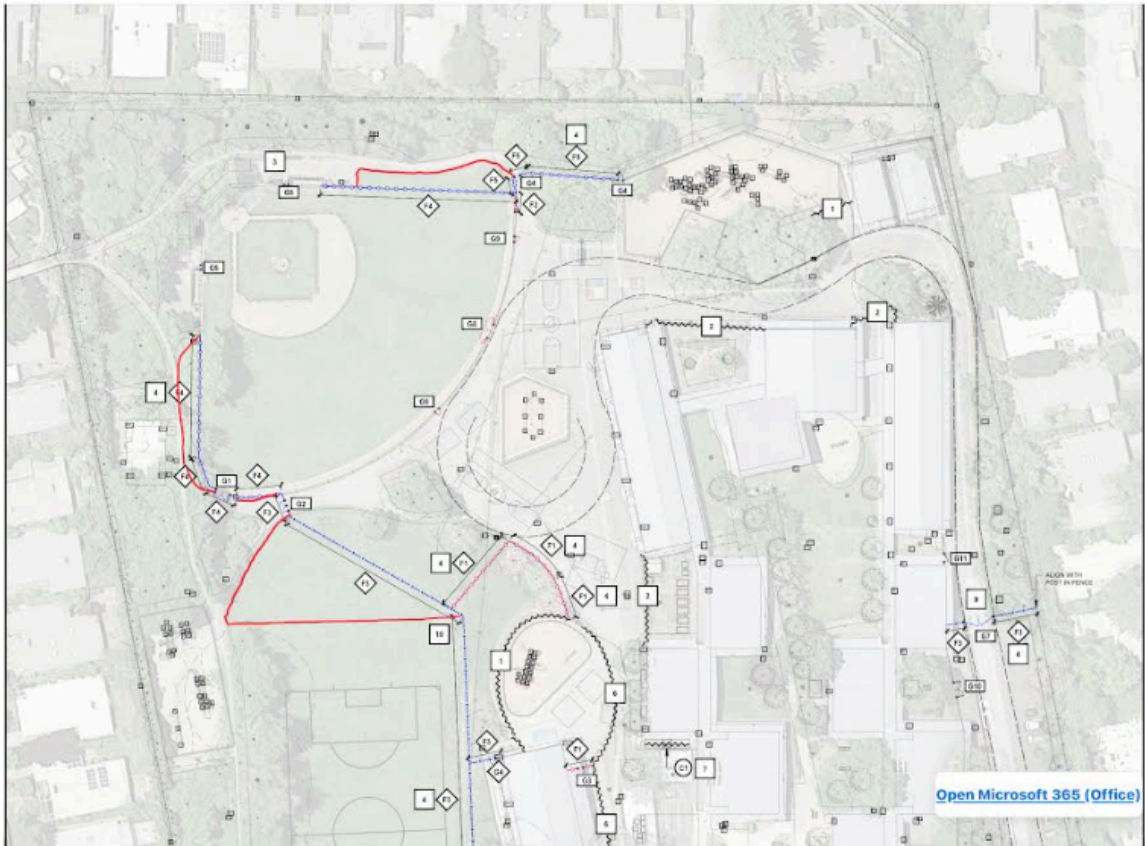

Tonight, staff is bringing the schematic design for Board approval and is recommending that the Board approve the design, as presented.