

PROPOSED LOCATION OF BIO-RETENTION AREA

PROPOSED LOCATION OF BIO-RETENTION AREA

co+ed
architecture

1205 happy valley avenue
san jose, ca 95129
408.761.3851
www.coedarchitecture.com

U&R
UNDERWOOD & ROSENBLUM, INC.
civil engineers and surveyors
1625 Ontario Street, Ste. 4114 San Jose, Ca 95131
Tel. No. (408) 433.1222 www.uand.com

REGISTERED PROFESSIONAL ENGINEER
FRANK M. ROSENBLUM
Exp. 3-31-24
No. 42857
CIVIL
STATE OF CALIFORNIA

PROJECT NO. J18114

LEGEND & ABBREVIATION

- TCM #**
BIO-RETENTION - INFILTRATION ALLOWED (1-2)
- NEW CONCRETE SLAB
(4" REINFORCED PCC ON 4" CLASS 2 AB
ON 6" RECOMPACTED SUBGRADE (90%))
- NEW AC PAVEMENT
(3" AC ON 9" CLASS 2 AB ON
6" RECOMPACTED SUBGRADE (95%))
- NEW STORM DRAIN
SIZE AND SLOPE AS INDICATED
- NEW PVC SUBDRAIN (SIZE AS INDICATED)
- CB CATCH BASIN
- RWL RAIN WATER LEADER
- COTG/SDCOO CLEAN OUT TO GRADE
- IMP IMPERVIOUS
- PER PERVIOUS
- SF SQUARE FEET
- TMC TREATMENT CONTROL MEASURE

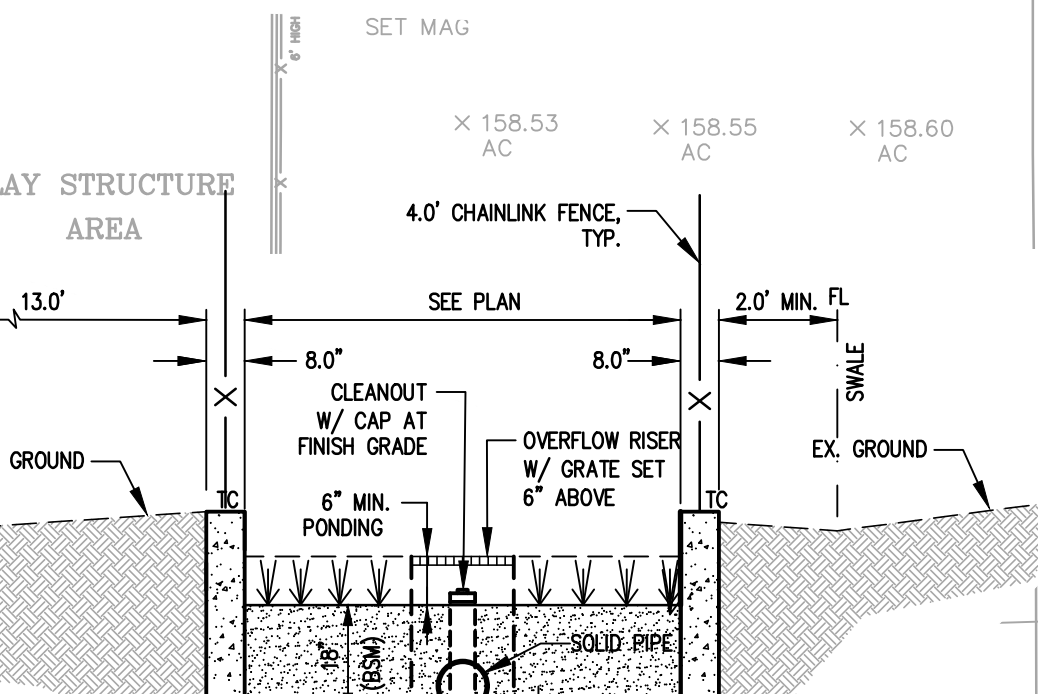
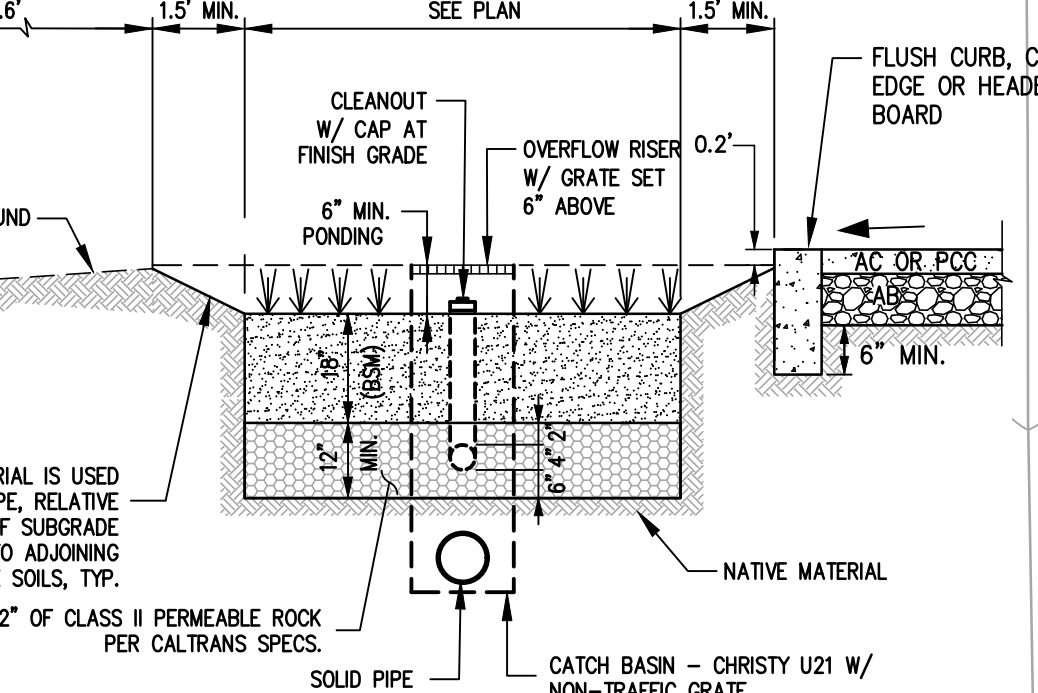
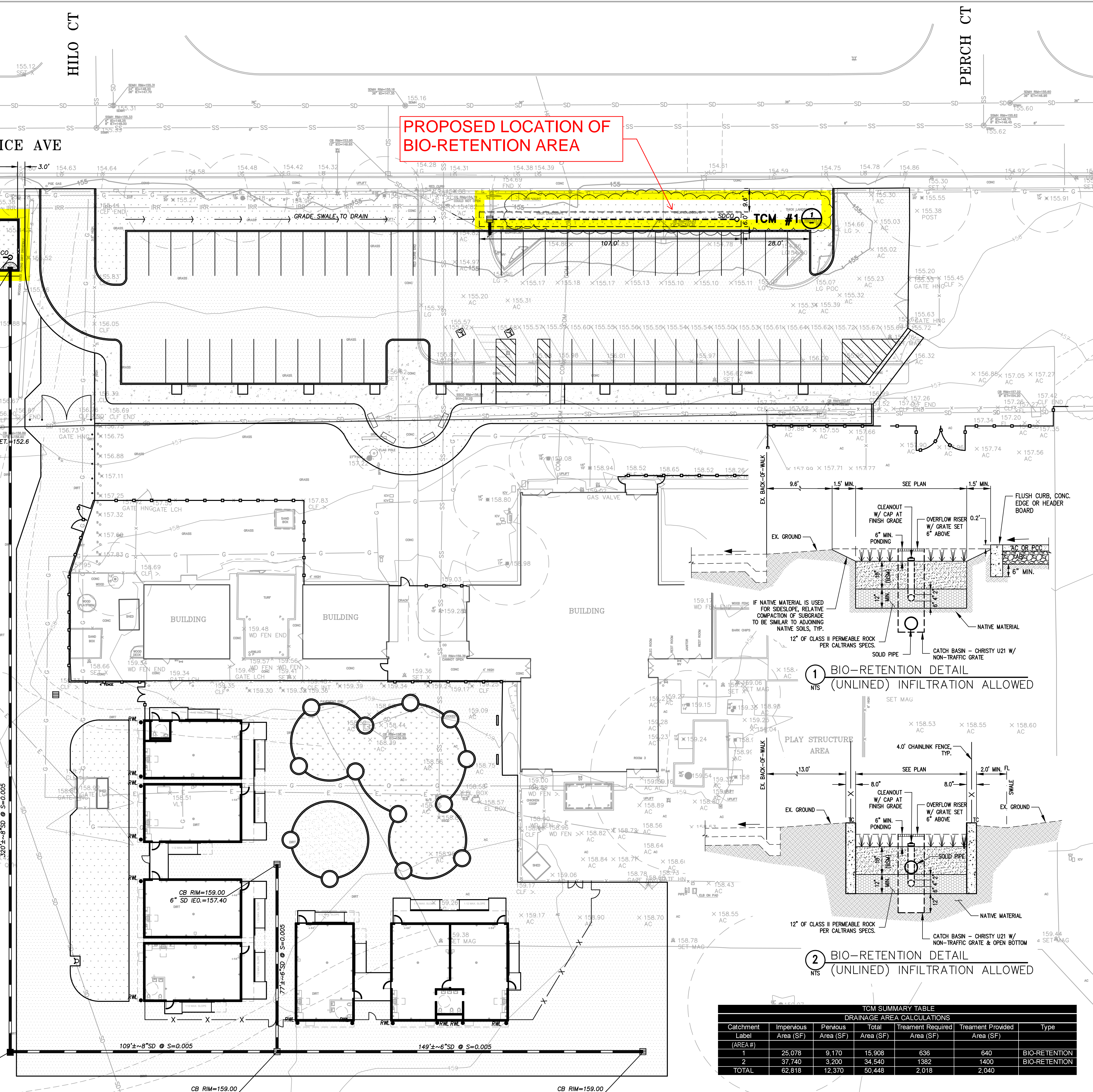

TCM SUMMARY TABLE
DRAINAGE AREA CALCULATIONS

Catchment Label (AREA #)	Impervious Area (SF)	Pervious Area (SF)	Total Area (SF)	Treatment Required Area (SF)	Treatment Provided Area (SF)	Type
1	25,078	9,170	15,908	636	640	BIO-RETENTION
2	37,740	3,200	34,540	1382	1400	BIO-RETENTION
TOTAL	62,818	12,370	50,448	2,018	2,040	

LEGEND

SYMBOL	DESCRIPTION
(1-2)	BIO-RETENTION - INFILTRATION ALLOWED

Project Title
**ACTION DAY SCHOOLS
CHILDCARE CENTER**
NEW RELOCATABLE BUILDINGS
O.J. COOPER SCHOOL
MOUNTAIN VIEW WHISMAN SCHOOL DISTRICT
333 EUNICE AVENUE
MOUNTAIN VIEW, CA 94040

No.	Description	Date
	Kick-Off Meeting	10/04/23
	Meeting Revisions	10/04/23

Drawing Title
**PROPOSED BIO-RETENTION
EXHIBIT**

Date	Project No.	Drawing No.
10/04/23	180221	1