



Mountain View  
Whisman  
School District

# District-Wide HVAC Modernization Project Phase 5

September 21, 2023



Mountain View  
Whisman  
School District

# Scope of Work

# District-Wide HVAC Modernization Project

Project Goals: replace aging mechanical units, electrify mechanical systems, standardize controls across the District

- **Phase 1:** Completed Summer 2021
  - Focus: Classrooms at Bubb, Graham, Imai, Landels, and Mistral
- **Phase 2:** Completed Summer 2022
  - Focus: Classrooms at Crittenden, Monta Loma, and Theuerkauf
- **Phase 3:** Scheduled completion Winter 2023/24
  - Focus: Library buildings at Bubb, Imai, and Landels
- **Phase 4:** Scheduled completion Summer '24
  - Focus: Replacing / integrating miscellaneous outdated controls across all campuses
- **Phase 5:** Scheduled completion Summer '24
  - Focus: Replace misc. units not yet replaced in Phases 1-4

# Before Images: Phase 5



Crittenden Middle School, Building 800



Monta Loma Elementary School, Portables



Mountain View  
Whisman  
School District

# Proposed Plans

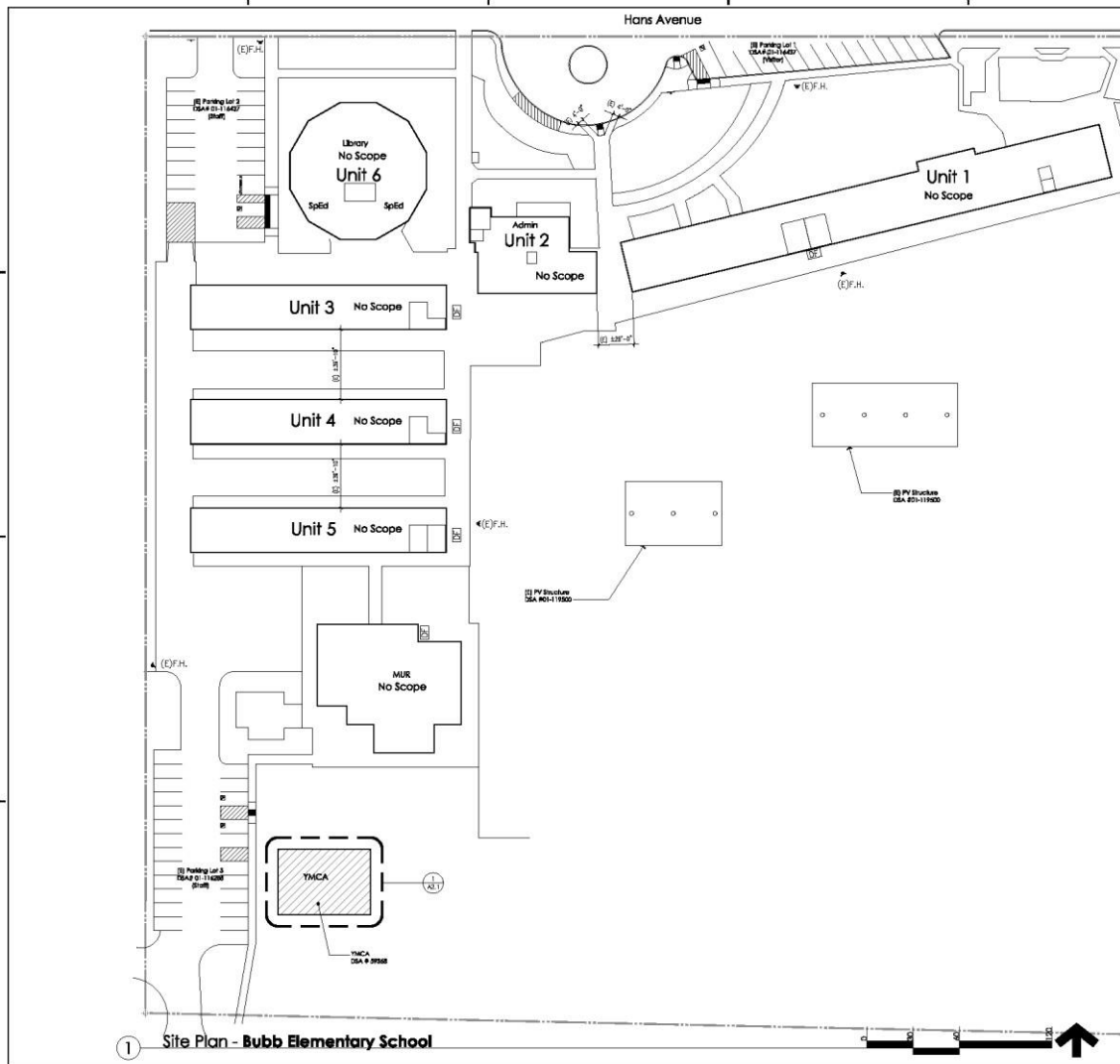

**Site Notes**

Contractor shall coordinate staging areas with District Construction Manager prior to proceeding.

**Electrical**

As the equipment will be replaced in kind, there will not be a change in load and the existing electrical service will be sufficient.

---

**Legend**

Building in scope of work. Replace (E) HVAC units with (R) per Mechanical drawings

---

**DSA Project No.**

Bldg. Unit 1 : 11321, 01-102392, 01-104154, 01-103399  
 Bldg. Unit 2 : 11321, 83274, 01-120389  
 Bldg. Unit 3 : 11320, 01-102392, 01-104154, 01-103399  
 Bldg. Unit 4 : 11320, 01-102392, 01-104154, 01-103399  
 Bldg. Unit 5 : 18021, 01-102392, 01-104154, 01-103399  
 Bldg. Unit 6 : 24620, 01-104154, 01-103399  
 MUR : 01-118288

**Site Accessibility:** 01-118488, 01-118296, 01-118528,  
 Drop off  
 Parking  
 Drinking fountains  
 Toilets

---

**Building Information**

| Building | Description | OCC | Condit. Type | Sp/Ret/Sec'd |
|----------|-------------|-----|--------------|--------------|
| Unit 1   | Classroom   | E   | V-B          | No           |
| Unit 2   | Admin       | B   | V-B          | No           |
| Unit 3   | Classroom   | E   | V-B          | No           |
| Unit 4   | Classroom   | E   | V-B          | No           |
| Unit 5   | Classroom   | E   | V-B          | No           |
| Unit 6   | Library     | B/C | V-A          | No           |
| MUR      | Multi       | J2  | V-B          | Yes          |

**DTA**  
 Dreiling Terrones Architecture Inc.  
 Architecture | Infrastructure | Environments  
 4800 JVA Street  
 Mountain View, CA 94038  
 415.948.1300  
 3011 Castro Street #200  
 Mountain View, CA 94031  
 415.948.1300

HVAC Replacement at  
**Benjamin Bubb Elementary School**  
 535 Hans Ave  
 Mountain View, CA

Revised Design to Match 04/24/2023

Bubb Elementary School  
 Site Plan

A1.1

2319

# Bubb Elementary School

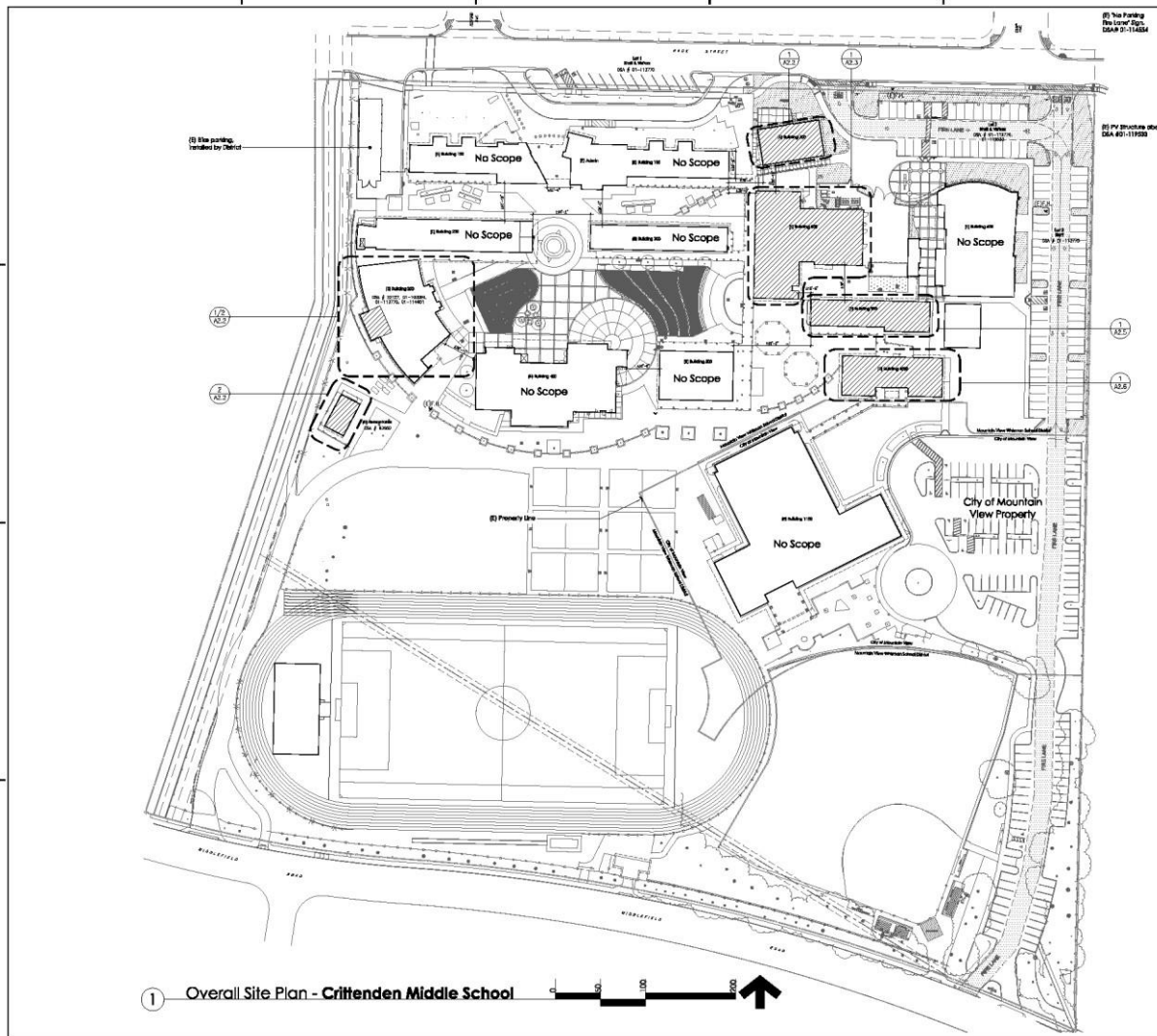

1 Overall Site Plan - Crittenden Middle School

### Site Notes

Contractor shall coordinate staging areas with District Construction Manager prior to proceeding.

**Electrical**  
Following analysis by Alliance Engineering Consultants, Inc., the existing service is appropriate for the new loads. See below for electrical load analysis:

|  |              |
|--|--------------|
| DSAF Acad. No.                               | 3423954133-4 |
| Historic Peak Annual Demand                  | 774.70 kW    |
| Existing Max. Demand                         | 543.30 kW    |
| New Load Added                               | 0.38 kW      |
| New Total Demand Load                        | 543.70 kW    |
| Existing Switchboard Capacity (based on 80%) | 1,330.00 kW  |

|  |              |
|--|--------------|
| DSAF Acad. No.                               | 6108272185-2 |
| Historic Peak Annual Demand                  | 123.70 kW    |
| Existing Max. Demand                         | 154.70 kW    |
| New Load Added                               | 0.00 kW      |
| New Total Demand Load                        | 154.70 kW    |
| Existing Switchboard Capacity (based on 80%) | 796.00 kW    |

### Legend

Building in scope of work. Replace (E) HVAC units with (K) per Mechanical drawings

### DSA Project No.

**Blg. 100 :** 6877, 6745, 01-10004, 01-11370, 01-119715, 01-12040  
**Blg. 200 :** 22127, 01-10094, 01-11370, 01-114601, 01-119715, 01-12040  
**Blg. 300 :** 19922, 63086, 01-10094, 01-11370, 01-119715, 01-12040  
**Blg. 400 :** 01-114601, 01-12040  
**Blg. 500 :** 24370, 01-10094, 01-11370, 01-119715, 01-12040  
**Blg. 600 :** 01-114504  
**Blg. 700 :** 19927, 01-10094, 01-11370, 01-12040  
**Blg. 800 :** 12395, 01-10093, 01-10094  
**Blg. 900 :** 12395, 01-10094, 01-11370, 01-12040  
**Blg. 1000 :** 19237, 21227, 01-10094  
**Blg. 1100 :** 56238

**Site Accessibility :** 01-11370, 01-114504, 01-12040  
 Drop off  
 Drop  
 Drop  
 Drop

### Building Information

| Building | Description       | OCC    | Const. Type | Sp/Weathered | No |
|----------|-------------------|--------|-------------|--------------|----|
| 100      | Algebra Classroom | B / E  | V-B         | No           |    |
| 200      | Classroom         | E      | V-A         | No           |    |
| 300      | Classroom         | E      | V-B         | No           |    |
| 400      | Library/Classroom | A3 / E | II-B        | Yes          |    |
| 500      | Classroom         | E      | V-B         | No           |    |
| 600      | Auditorium        | All    | I-B         | Yes          |    |
| 700      | Classroom         | E      | V-B         | No           |    |
| 800      | MPE/Visitors      | E / F1 | V-B         | No           |    |
| 900      | Classroom         | E      | V-B         | No           |    |
| 1000     | Lecture/Theater   | E      | V-B         | No           |    |
| 1100     | Sport Center      | A3     | II-B        | Yes          |    |

**DTA**  
 Dreiling Terrones Architecture Inc.  
 Architecture | Infrastructure | Environments  
 1701 Park St.  
 Mountain View, CA  
 95040-4133  
 408.648.1300  
 311 E. Calaveras Street #202  
 Mountain View, CA 95035  
 408.648.1300

HVAC Replacement at  
**Crittenden Middle School**  
 1701 Park St.  
 Mountain View, CA

Revised: Design to Award 01/21/2024

Crittenden Middle School  
 Site Plan

A1.1

2319

# Crittenden Middle School

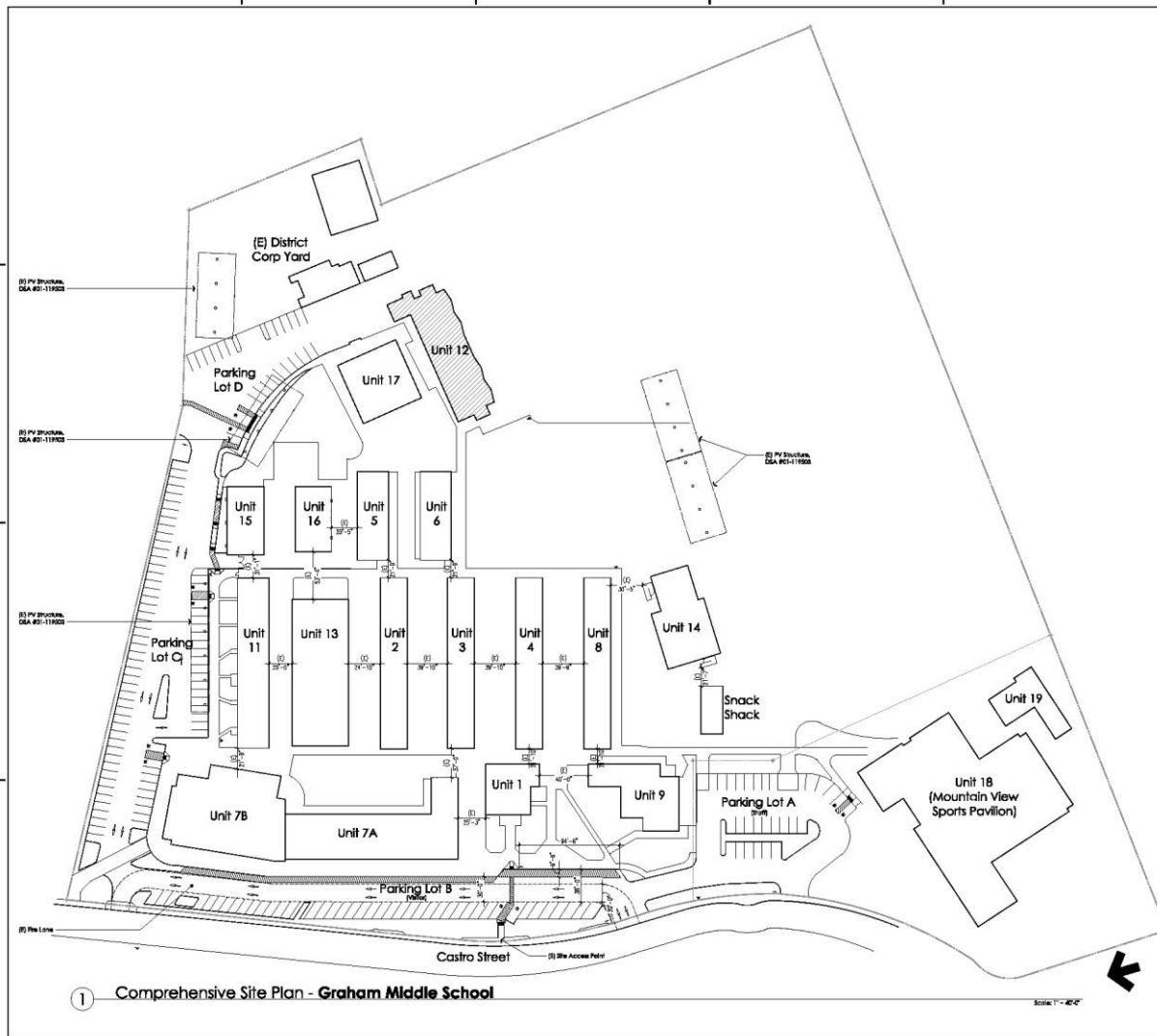

① Comprehensive Site Plan - Graham Middle School

Scale: 1" = 40'-0"

**Site Notes**

Contractor shall coordinate staging areas with District Construction Manager prior to proceeding.

**Electrical**  
Following analysis by Alliance Engineering Consultants, Inc., the existing service is appropriate for the new loads. See below for electrical load analysis:

|  |              |
|--|--------------|
| DP&E Acct. No.                               | 348206-300-4 |
| Historic Peak Annual Demand                  | 264.0 kW     |
| Existing Max. Demand                         | 360.0 kW     |
| New Load Added                               | 45.0 kW      |
| New Total Demand Load                        | 350.4 kW     |
| Existing Switchboard Capacity (based on BUS) | 854.0 kW     |

**Legend**

Building in scope of work, Replace (E) HVAC units with (R) per Mechanical drawings

**DSA Project No.**

**Build Unit 1:** 15093, 83324, 01-114460, 01-120405  
**Build Unit 2:** 12093, 01-113776, 01-114460, 01-120405  
**Build Unit 3:** 15093, 01-113776, 01-120405  
**Build Unit 4:** 15093, 01-113776, 01-114460, 01-120405  
**Build Unit 5:** 12093, 18574, 01-102477, 01-113776, 01-120405  
**Build Unit 6:** 15093, 18574, 01-102477, 01-113776, 01-120405  
**Build Unit 7A:** 15093, 01-113776, 01-120405  
**Build Unit 7B:** 01-114460  
**Build Unit 7C:** 60094, 01-113776, 01-114460, 01-130405  
**Build Unit 8:** 14574, 01-113776, 01-120405  
**Build Unit 9:** 01-102477, 01-113776, 01-114460, 01-120405  
**Build Unit 10:** 80094, 01-114460  
**Build Unit 11:** 80094, 01-113776  
**Build Unit 12:** 01-114460  
**Build Unit 13:** 01-114517, 01-120405  
**Build Unit 14:** 01-110201  
**Build Unit 15:** 01-102514  
**Build Unit 16:** 80094, 01-114460  
**Build Unit 17:** 01-102502  
**Build Unit 18:** 01-114460  
**Build Unit 19:** 01-114460  
**Snack Shack:** 01-114460  
**PV Structures:** 01-114460

**Site Accessibility:** 60094, 83324, 01-102477, 01-102382, 01-112776, 01-114460, 01-114517, 01-114524, 01-118632, 01-120405  
 Installing: Drop-off, Parking, Drinking, First Aid

**Building Information**

| Building | Description     | OCC | Const. type | Sprinkered |
|----------|-----------------|-----|-------------|------------|
| Unit 1   | Library         | A3  | V-B         | No         |
| Unit 2   | Classroom       | E   | V-B         | No         |
| Unit 3   | Classroom       | E   | V-B         | No         |
| Unit 4   | Classroom       | E   | V-B         | No         |
| Unit 5   | Classroom       | E   | V-B         | No         |
| Unit 6   | Classroom       | E   | V-B         | No         |
| Unit 7A  | Music Classroom | E   | V 118F      | No         |
| Unit 7B  | Auditorium      | E   | V-B         | No         |
| Unit 8   | Classroom       | E   | V-B         | No         |
| Unit 9   | Admin           | B   | V-B         | No         |
| Unit 11  | Classroom       | E   | V-B         | No         |
| Unit 13  | Classroom       | E   | V-B         | No         |
| Unit 14  | Classroom       | E   | V-B         | No         |
| Unit 15  | Classroom       | E   | V-B         | No         |
| Unit 16  | Classroom       | E   | V-B         | No         |
| Unit 18  | Classroom       | E   | V-B         | No         |

**DTA**  
 Dreiling Terrones Architecture Inc.  
 Architecture | Infrastructure | Environments  
 1175 Castro St  
 Mountain View, CA  
 94031-3303  
 415.948.1300  
 311 Castro Street #202  
 Mountain View, California  
 94031-3303

**HVAC Replacement at**  
**Graham Middle School**  
 1175 Castro St  
 Mountain View, CA

Submittal Design to North #1/21/2023

Graham Middle School  
 Site Plan

A1.1

2319

# Graham Middle School



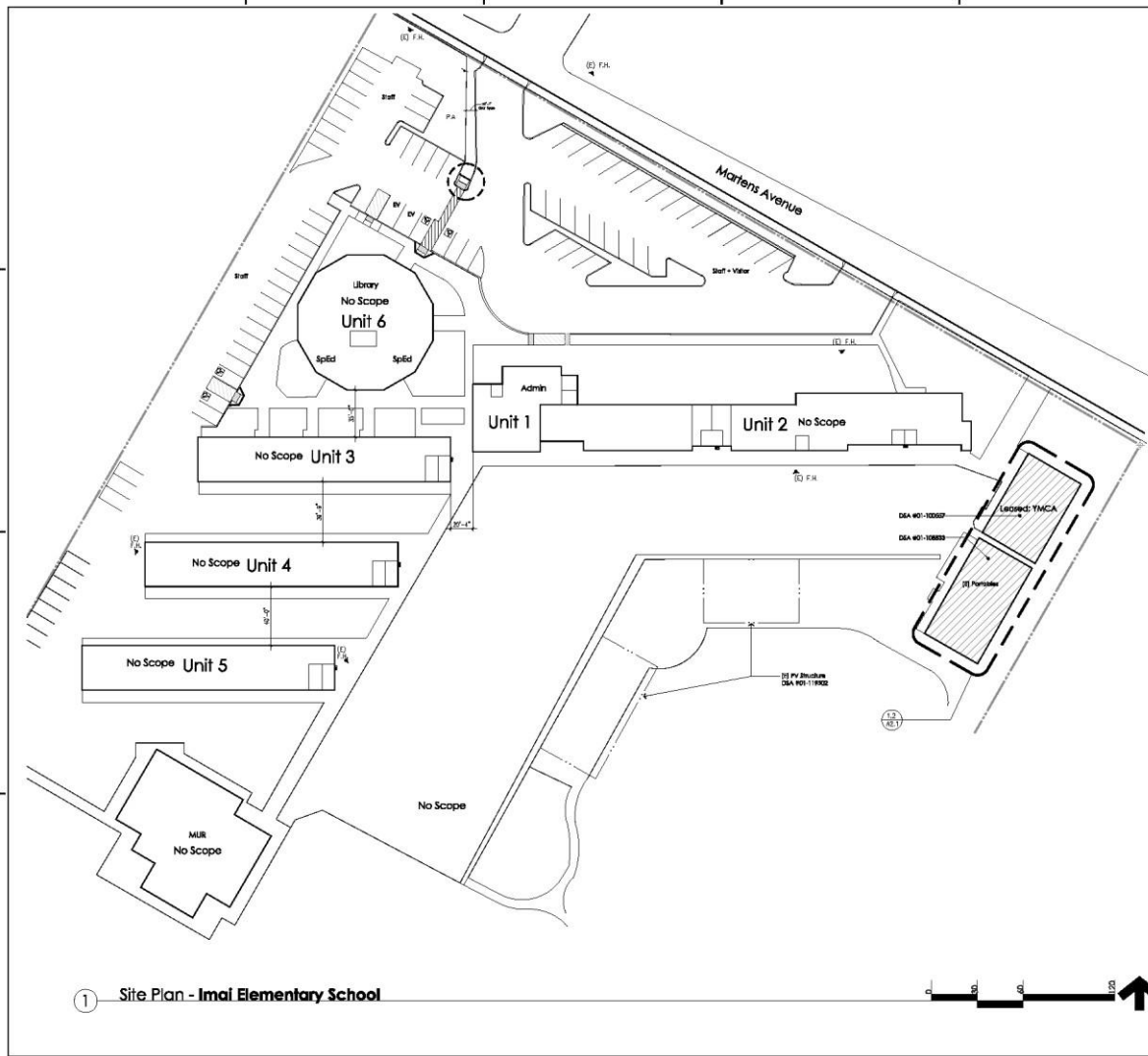

① Site Plan - Imai Elementary School

**Site Notes**  
 Contractor shall coordinate staging areas with District Construction Manager prior to proceeding.  
**Electrical**  
 As the equipment will be replaced in kind, there will not be a change in load and the existing electrical service will be sufficient.

**Legend**  
 Building in scope of work. Replace (E) HVAC units with (R) per Mechanical drawings

**Building Information**

| Building | Description       | OCC   | Constr. Type | Spring/kered |
|----------|-------------------|-------|--------------|--------------|
| Unit 1   | Classroom/Storage | E/S-1 | V-B          | No           |
| Unit 2   | Classroom         | E     | V-B          | No           |
| Unit 3   | Classroom/Storage | E/S-1 | V-B          | No           |
| Unit 4   | Classroom/Storage | E/S-1 | V-B          | No           |
| Unit 5   | Classroom/Storage | E/S-1 | V-B          | No           |
| Unit 6   | Library/Classroom | JL    | V-A          | No           |
| MUR      | MUR               | E     | V-B          | Yes          |

**DSA Project No.**

Unit 1: 15398, 01-106214, 01-118928, 01-120401  
 Unit 2: 15398, 01-106318, 01-118928, 01-120401  
 Unit 3: 15398, 01-106318, 01-102044, 01-118928, 01-120401  
 Unit 4: 16217, 01-106318, 01-102044, 01-118928, 01-120401  
 Unit 5: 204177, 01-106318, 01-102044, 01-118928, 01-120401  
 Unit 6: 204021, 48284, 01-104182, 01-118928, 01-120401  
 MUR: 01-118289

**Site Accessibility:** 01-102318, 01-109933, 01-118478, 01-118929  
 Drop off  
 Pick-up  
 Drop-off/Pick-up  
 Office

**DTA**  
 Dreiling Terrones Architecture Inc.  
 Architecture | Infrastructure | Environments  
 3830 Alameda Avenue, Suite 200  
 Mountain View, California  
 94039-3103  
 415.948.1303  
 311 E. Calaveras Street #202  
 Redwood City, California  
 94061  
 650.745.1303

HVAC Equipment of  
**Army Imai Elementary School**  
 383 Alameda Ave.  
 Mountain View, CA

Revised/Change to Search 01/28/2023

Army Imai  
 Elementary School  
 Site Plan

**A1.1**

2319

# Imai Elementary School

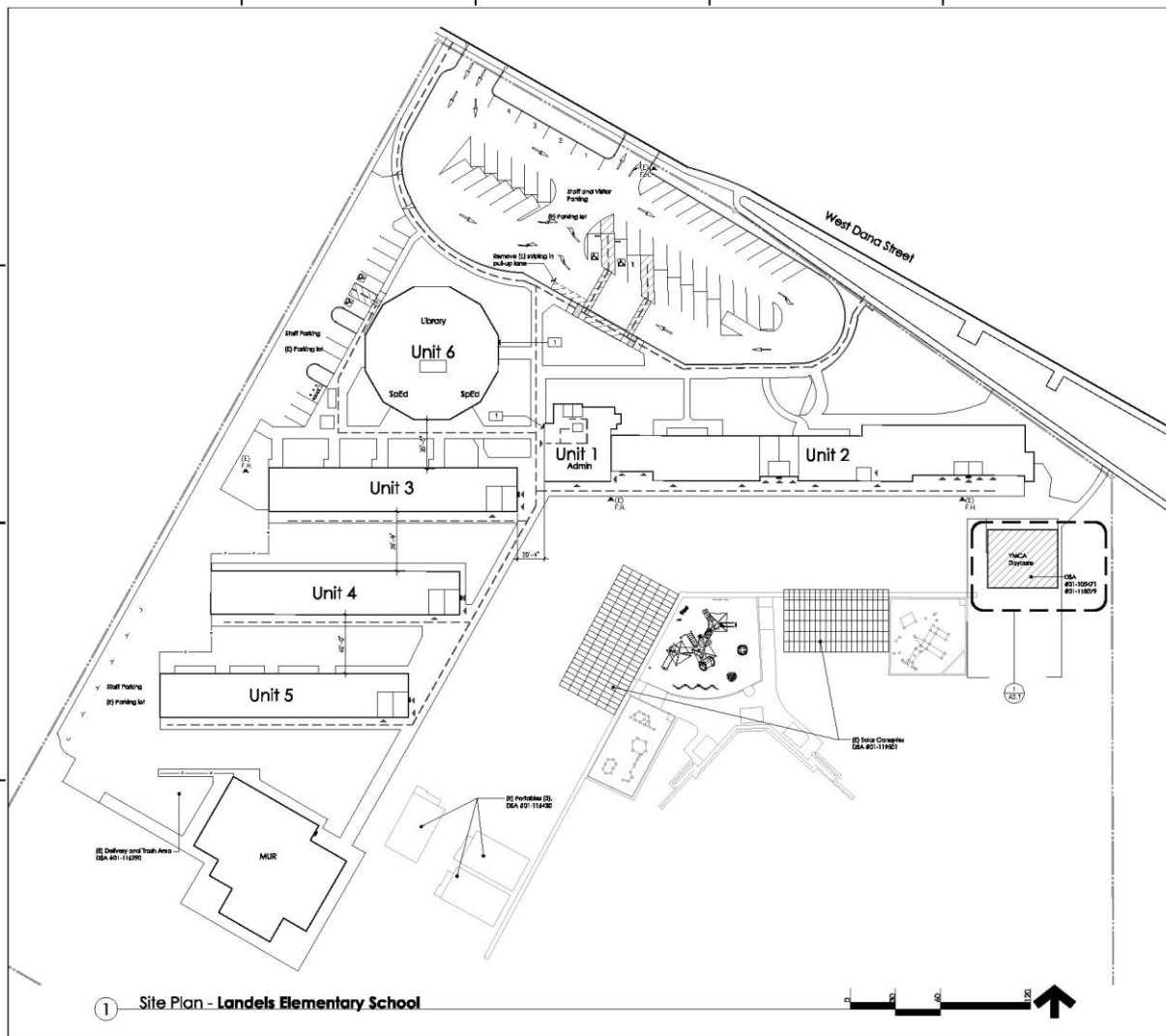

1 Site Plan - Landels Elementary School

**Site Notes**

Contractor shall coordinate staging areas with District Construction Manager prior to proceeding.

**Electrical**  
As the equipment will be replaced in kind, there will not be a change in load and the existing electrical service will be sufficient.

---

**Legend**

Building in scope of work. Replace (E) HVAC units with (R) per Mechanical drawings

---

**Building Information**

| Building | Description       | OCC     | Conf. Type | Sprinklered |
|----------|-------------------|---------|------------|-------------|
| Unit 1   | Admin/Storage     | B/S-1   | V-B        | No          |
| Unit 2   | Classroom         | E       | V-B        | No          |
| Unit 3   | Classroom/Storage | E/S-1   | V-B        | No          |
| Unit 4   | Classroom/Sp./St  | E/S/S-1 | V-B        | No          |
| Unit 5   | Classroom/Sp./St  | E/S/S-1 | V-B        | No          |
| Unit 6   | Library/Classroom | A2      | V-A        | No          |
| MUR      | MUR               | E       | V-B        | Yes         |

---

**DSA Project No.**

**Unit 1:** 17147, 34478, 01-103485, 01-116933, 01-120462  
**Unit 2:** 17147, 01-102382, 01-103485, 01-116933, 01-120462  
**Unit 3:** 17147, 01-102382, 01-103485, 01-116933, 01-120462  
**Unit 4:** 17147, 01-102382, 01-103485, 01-116933, 01-120462  
**Unit 5:** 18025, 01-102382, 01-103485, 01-116933, 01-120462  
**Unit 6:** 29402, 00-104184, 01-116933, 01-120462  
**MUR:** 01-116390  
**Site Accessibility:** 01-118290, 01-116933, 01-116430

Drop off Parking Drawing/Title sheets

**DTA**  
 Dreiling Terrones Architecture Inc.  
 Architecture | Infrastructure | Environments  
 1115 W. Dana St.  
 Mountain View, CA 94035  
 650.949.1205  
 311 Center Street, Suite 1002  
 Mountain View, CA 94035  
 707.451.1300

HVAC Replacement at  
**Landels Elementary School**  
 1115 W Dana St  
 Mountain View, CA

Schematic Design in Record 08/28/2023

Landels Elementary School  
 Site Plan

A1.1

2319

# Landels Elementary School

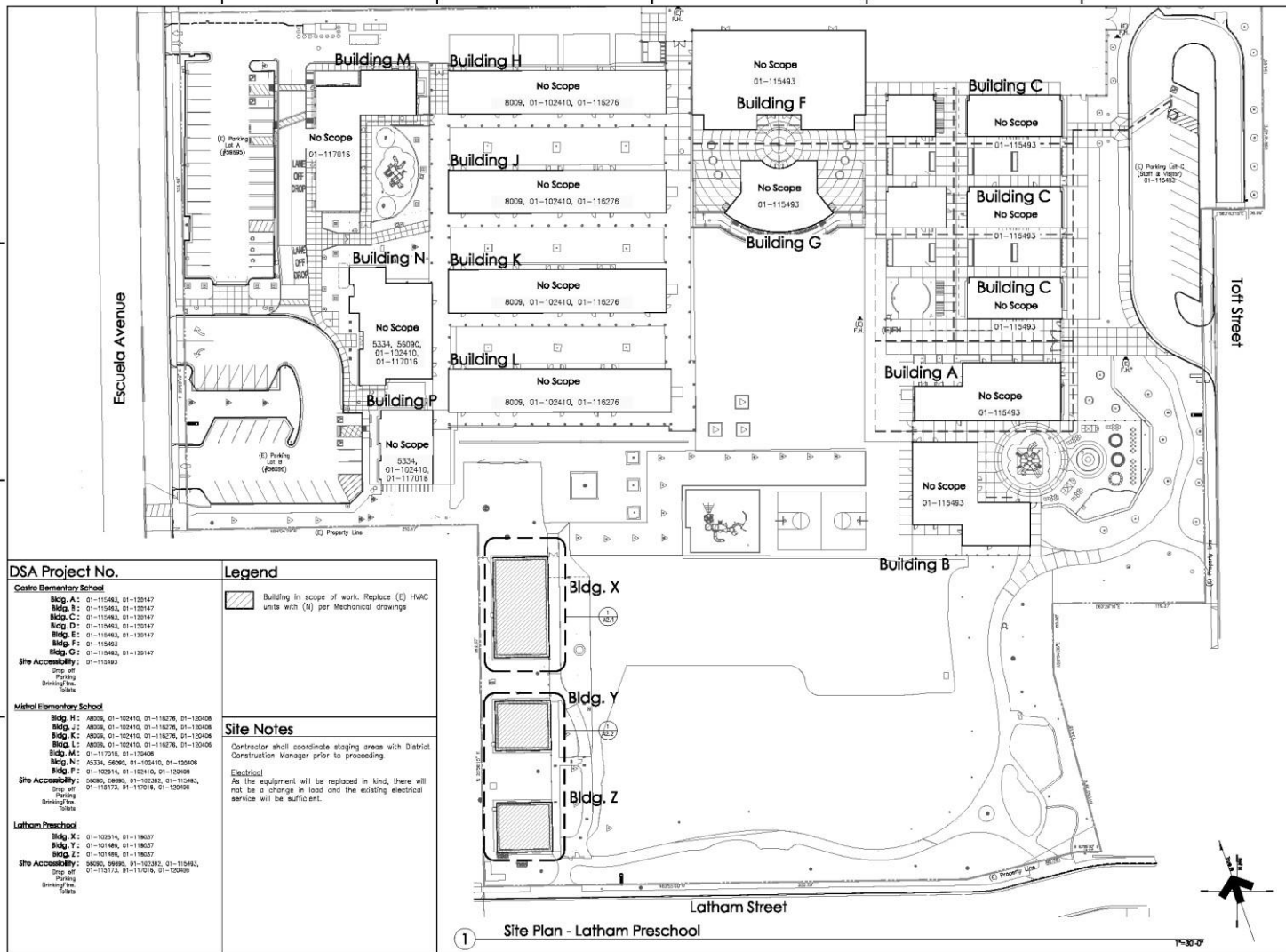

**DTA**  
 Drilling Terrones Architecture Inc.  
 Architecture | Infrastructure | Environments  
 1850 Latham St.  
 Mountain View, CA  
 95031  
 408.948.1300  
 311 E. Center Street #202  
 Mountain View, CA 95031  
 408.948.1300

HVAC Replacement at  
**Latham Preschool**  
 1850 Latham St.  
 Mountain View, CA

Submittal/Change to Search #2/23/2023

Latham Preschool  
 Site Plan

**A1.1**  
 2319

# Latham Preschool

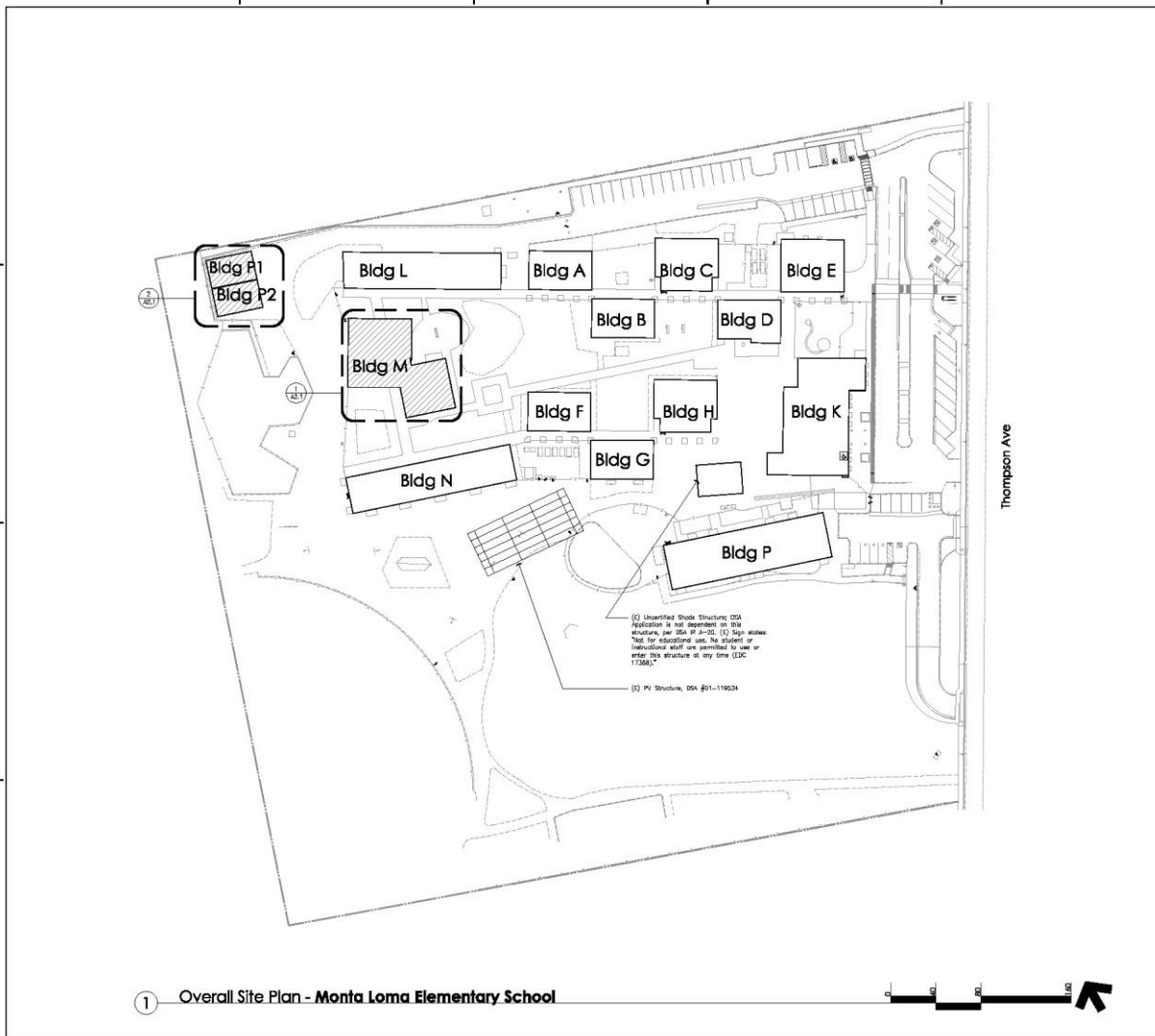

1 Overall Site Plan - Monta Loma Elementary School

**Site Notes**

Contractor shall coordinate staging areas with District Construction Manager prior to proceeding.

**Electrical**  
 Following analysis by Alliance Engineering Consultants, Inc., the existing service is appropriate for the new loads. However, a new panel will need to be installed for the new HVAC equipment. See below for electrical load analysis:

|  |             |
|--|-------------|
| PEAE Acct. No.                               | 745469300-0 |
| Historic Peak Annual Demand                  | 200 kVA     |
| Existing Max. Demand                         | 250 kVA     |
| New Load Added                               | 0 kVA       |
| New Total Demand Load                        | 250 kVA     |
| Existing Switchboard Capacity (based on 80%) | 461 kVA     |

|  |              |
|--|--------------|
| PEAE Acct. No.                               | 7413709536-1 |
| Historic Peak Annual Demand                  | 150.3 kVA    |
| Existing Max. Demand                         | 156.7 kVA    |
| New Load Added                               | 51.1 kVA     |
| New Total Demand Load                        | 207.7 kVA    |
| Existing Switchboard Capacity (based on 80%) | 230.0 kVA    |

**Legend**

Building in scope of work. Replace (C) HVAC units with (N) per Mechanical drawings

**Building Information**

| Building | Description  | OCC | Const. Type | Spri/terrac |
|----------|--------------|-----|-------------|-------------|
| Bldg. A  | Classroom    | E   | V-B         | No          |
| Bldg. B  | Classroom    | E   | V-B         | No          |
| Bldg. C  | Classroom    | E   | V-B         | No          |
| Bldg. D  | Staff Lounge | B   | V-B         | No          |
| Bldg. E  | Admin.       | Q1  | V-B         | No          |
| Bldg. F  | Classroom    | E   | V-B         | No          |
| Bldg. G  | Classroom    | E   | V-B         | No          |
| Bldg. H  | Classroom    | E   | V-B         | No          |
| Bldg. I  | Admin.       | Q1  | V-B         | No          |
| Bldg. J  | Classroom    | E   | V-B         | No          |
| Bldg. K  | Classroom    | E   | V-B         | No          |
| Bldg. L  | Classroom    | E   | V-B         | No          |
| Bldg. M  | Library      | E   | V-B         | No          |
| Bldg. N  | Classroom    | E   | V-B         | No          |
| Bldg. O  | Classroom    | E   | V-B         | No          |
| Bldg. P1 | Classroom    | E   | V-B         | No          |
| Bldg. P2 | Classroom    | E   | V-B         | No          |

**DSA Project No.**

- Bldg. A:** 12641, 02787, 01-101385, 01-116344, 01-116426, 01-116716, 01-120404
- Bldg. B:** 12650, 02729, 01-101385, 01-116344, 01-116426, 01-116716
- Bldg. C:** 12641, 01-101385, 01-116426, 01-116344, 01-116426, 01-116716
- Bldg. D:** 12641, 01-101385, 01-116426, 01-120404
- Bldg. E:** 12641, 01-101385, 01-116426, 01-120404
- Bldg. F:** 14728, 01-101385, 01-116344, 01-116426, 01-116716
- Bldg. G:** 14728, 01-101385, 01-116426, 01-116426, 01-116716
- Bldg. H:** 12641, 01-101385, 01-116426, 01-116426, 01-116716
- Bldg. K:** 12641, 01-101327, 01-116426
- Bldg. L:** 01-101385, 01-116344, 01-116426, 01-116716, 01-120404
- Bldg. M:** 01-101385, 01-116426, 01-120404
- Bldg. N:** 01-101385, 01-116344, 01-116426, 01-116716, 01-120404
- Bldg. P:** 01-101385, 01-116344, 01-116426, 01-116716, 01-120404
- Bldg. P1 & P2:** 01-116780

**Site Accessibility:**  
 01-116464, 01-116426, 01-116444  
 01-101385, 01-116344 (not yet certified)  
 Date: 07/11/2024  
 Drawing No.: 2319  
 Title: HVAC

**DTA**  
 Dreiling Terrones Architecture Inc.  
 Architecture | Infrastructure | Environments  
 440 Thompson Ave  
 Mountain View, CA  
 94039-1305  
 925.948.1305  
 311 Center Street #202  
 Mountain View, CA 94039  
 P.O. Box 411303

HVAC Replacement at  
**Monta Loma Elementary School**  
 440 Thompson Ave  
 Mountain View, CA  
 94039-1305

Submittal Design to Search #1/21/2024

Monta Loma Elementary  
 Site Plan

**A1.1**  
 2319

# Monta Loma Elementary School

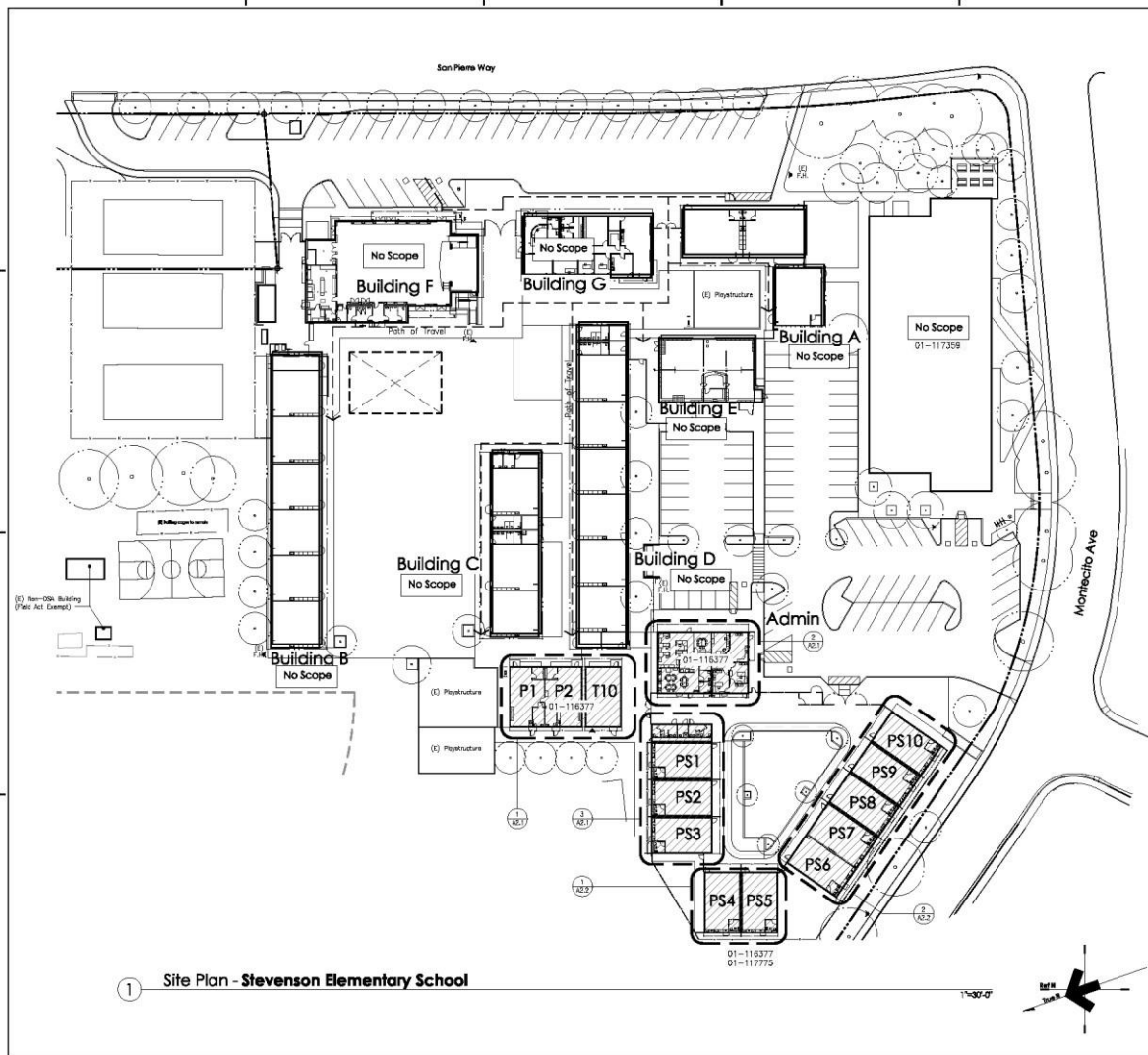

1 Site Plan - Stevenson Elementary School

**Site Notes**  
 Contractor shall coordinate staging areas with District Construction Manager prior to proceeding.  
**Electrical**  
 As the equipment will be replaced in kind, there will not be a change in load and the existing electrical service will be sufficient.

**Legend**  
 Building in scope of work. Replace (E) HVAC units with (R) per Mechanical drawings

**Building Information**

**DSA Project No.**

- Bldg. A, B, C, D, G 01-116489, 01-120149
- Bldg. E 01-116769, 01-120149
- P1, P2, T10; 01-116377
- PS1-PS10 01-116377, 01-117775

• Site Accessibility: 01-116489  
 - Drop off  
 - Parking  
 - Drinking/Water  
 - Toilets

**DTA**  
 Dreiling Terrones Architecture Inc.  
 Architecture | Infrastructure | Environments  
 10000 Wilshire Blvd., Suite 1000  
 Los Angeles, CA 90024  
 310.441.1300  
 311 E. Colton Street #1020  
 Mountain View, CA 94035  
 650.961.1303

HWAC Replacement of  
**Stevenson Elementary School**  
 2750 San Pleno Way  
 Mountain View, CA  
**MWSD District Office**  
 1100 Montecito Avenue  
 Mountain View, CA

Revised/Change to Search 01/23/2023

Site Plan

**A1.1**

2319

# Stevenson Elementary School / District Office

| Building Information          |                |     |              | DSA Project No. |  | Site Notes                             |  | Legend |                 |               |                             |          |                      |          |                |         |                       |          |                               |          |
|-------------------------------|----------------|-----|--------------|-----------------|--|--|--|--------|-----------------|---------------|-----------------------------|----------|----------------------|----------|----------------|---------|-----------------------|----------|-------------------------------|----------|
| Blgd                          | Description    | OCC | Constr. Type | Sprinklered     | Blgd. A                                | Blgd. B                                | Contractor shall coordinate staging areas with District Construction Manager prior to proceeding.  |        |                 |               |                             |          |                      |          |                |         |                       |          |                               |          |
| Blgd. A                       | Admin/Staff    | B   | V-B          | No              | 14418, 01-100141, 01-118658, 01-120403 | 10021, 01-100141, 01-118658            | <b>Electrical</b><br>Following analysis by Alliance Engineering Consultants, Inc, the existing service is appropriate for the new loads. See below for electrical load analysis:<br><br><table border="1"> <tr> <td>Prop. Add. Lvs.</td> <td>7944(2)3843-1</td> </tr> <tr> <td>Historic Peak Annual Demand</td> <td>154.0 kW</td> </tr> <tr> <td>Existing Max. Demand</td> <td>202.0 kW</td> </tr> <tr> <td>New Load Added</td> <td>12.6 kW</td> </tr> <tr> <td>New Total Demand Load</td> <td>215.6 kW</td> </tr> <tr> <td>Existing Switchboard Capacity</td> <td>864.0 kW</td> </tr> </table> (based on BUS) |        | Prop. Add. Lvs. | 7944(2)3843-1 | Historic Peak Annual Demand | 154.0 kW | Existing Max. Demand | 202.0 kW | New Load Added | 12.6 kW | New Total Demand Load | 215.6 kW | Existing Switchboard Capacity | 864.0 kW |
| Prop. Add. Lvs.               | 7944(2)3843-1  |     |              |                 |  |  |  |        |                 |               |                             |          |                      |          |                |         |                       |          |                               |          |
| Historic Peak Annual Demand   | 154.0 kW       |     |              |                 |  |  |  |        |                 |               |                             |          |                      |          |                |         |                       |          |                               |          |
| Existing Max. Demand          | 202.0 kW       |     |              |                 |  |  |  |        |                 |               |                             |          |                      |          |                |         |                       |          |                               |          |
| New Load Added                | 12.6 kW        |     |              |                 |  |  |  |        |                 |               |                             |          |                      |          |                |         |                       |          |                               |          |
| New Total Demand Load         | 215.6 kW       |     |              |                 |  |  |  |        |                 |               |                             |          |                      |          |                |         |                       |          |                               |          |
| Existing Switchboard Capacity | 864.0 kW       |     |              |                 |  |  |  |        |                 |               |                             |          |                      |          |                |         |                       |          |                               |          |
| Blgd. B                       | HRP            | A2  | V-B          | Yes             | 10021, 01-100141, 01-118658            | 01-100141, 01-118658, 01-120403        |  |        |                 |               |                             |          |                      |          |                |         |                       |          |                               |          |
| Blgd. C                       | Classroom      | E   | V-B          | No              | 14418, 01-100141, 01-118658, 01-120403 | 11418, 01-100141, 01-118658, 01-120403 |  |        |                 |               |                             |          |                      |          |                |         |                       |          |                               |          |
| Blgd. D                       | 1/2K Classroom | E   | V-B          | No              | 14418, 01-100141, 01-118658, 01-120403 | 46581, 01-100141, 01-118658, 01-120403 |  |        |                 |               |                             |          |                      |          |                |         |                       |          |                               |          |
| Blgd. E                       | Classroom      | E   | V-B          | No              | 01-109712, 01-118658, 01-118094        |  |  |        |                 |               |                             |          |                      |          |                |         |                       |          |                               |          |
| Blgd. F                       | Classroom      | B   | V-B          | No              |  |  |  |        |                 |               |                             |          |                      |          |                |         |                       |          |                               |          |
| Blgd. G                       | Classroom      | E   | V-B          | No              |  |  |  |        |                 |               |                             |          |                      |          |                |         |                       |          |                               |          |
| Blgd. H                       | Classroom      | E   | V-B          | No              |  |  |  |        |                 |               |                             |          |                      |          |                |         |                       |          |                               |          |
| Blgd. P                       | Library        | E   | V-B          | No              |  |  |  |        |                 |               |                             |          |                      |          |                |         |                       |          |                               |          |
| Blgd. V                       | Library        | E   | V-B          | No              |  |  |  |        |                 |               |                             |          |                      |          |                |         |                       |          |                               |          |

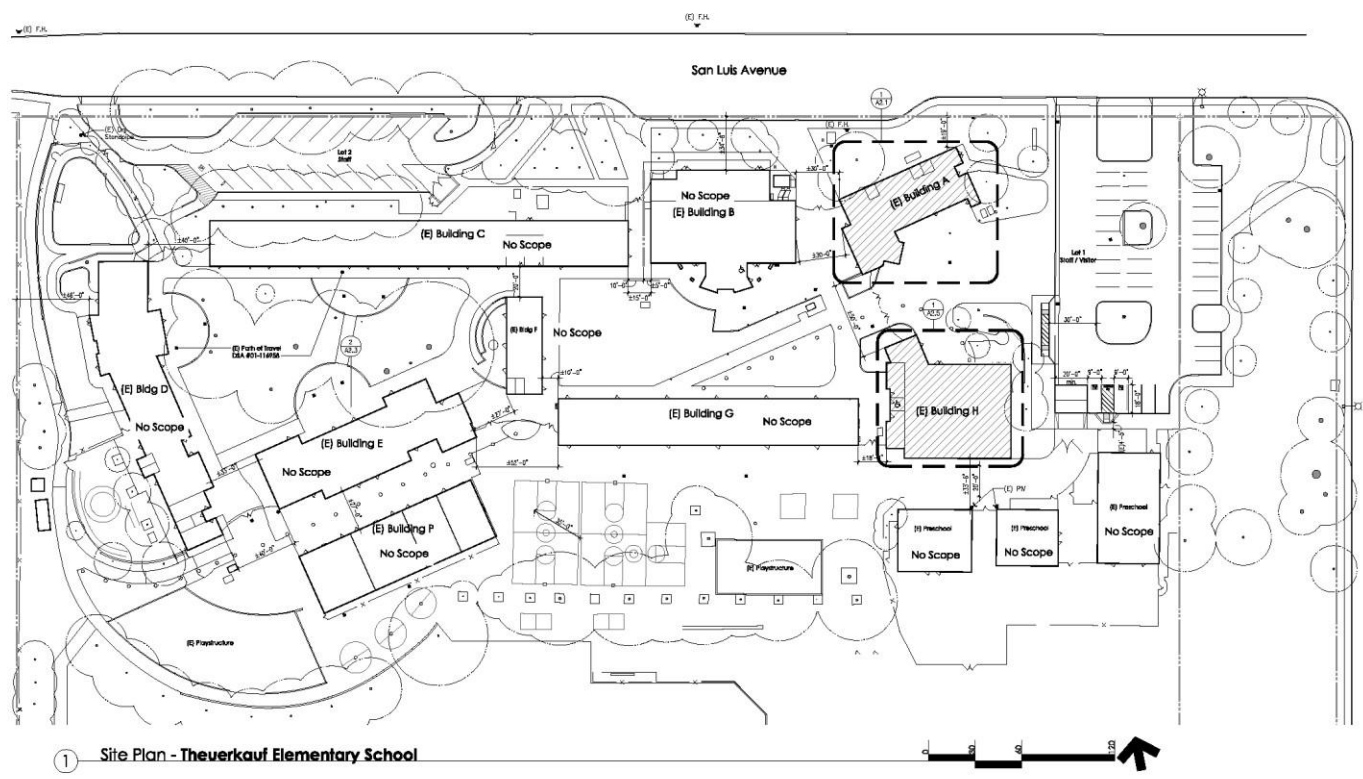

1 Site Plan - Theuerkauf Elementary School

**DTA**  
 Dreiling Terrones Architecture Inc.  
 13033 Avenue Commerce  
 Suite 200  
 Mountain View, CA 94039  
 415.948.1300  
 www.dtaarch.com  
 01/23/2023  
 01/23/2023  
 01/23/2023

HVAC Modernization at  
**Theuerkauf Elementary School**  
 1625 San Luis Ave  
 Mountain View, CA

Electronic Design by Inward 01/23/2023

Theuerkauf  
 Bementary School  
 Site Plan

A1.1

2319

# Theuerkauf Elementary School



Mountain View  
Whisman  
School District

# Proposed Budget

# Schematic Design Budget

| # | Description            | Quantity | Unit | Unit \$ | Total        |
|---|------------------------|----------|------|---------|--------------|
|   | Anticipated Bid Amount | 1        | ls   |         | \$ 2,423,627 |

## Project Cost

| Description                     | Quantity | Unit | Unit Cost  | Subtotal            |
|---------------------------------|----------|------|------------|---------------------|
| Construction Budget             | 1        | ls   |            | \$ 2,423,627        |
| Design Contingency              | 10       | %    |            | \$ 242,363          |
| Construction Contingency        | 10       | %    |            | \$ 242,363          |
| Architect Fees                  | 1        | ls   | \$ 328,000 | \$ 328,000          |
| Architect Contingency           | 8        | %    |            | \$ 19,389           |
| Architect Reimbursable Expenses | 7        | %    |            | \$ 22,960           |
| Blueprinting                    | 1        | ls   |            | \$ 2,500            |
| Topographic Survey              | 1        | ls   | \$ 30,000  | \$ 30,000           |
| Soils Report & Testing          | 0.5      | %    |            | \$ 12,118           |
| CM Fees                         | 4.5      | %    |            | \$ 109,063          |
| DSA Inspector                   | 8        | mos. | \$ 18,500  | \$ 148,000          |
| Testing Laboratory              | 0.5      | %    |            | \$ 12,118           |
| Bid Advertisements              | 1        | ls   |            | \$ 2,500            |
| DSA Fees                        | 1        | ls   | \$ 31,390  | \$ 31,390           |
| Legal                           | 1        | ls   | \$ 10,000  | \$ 10,000           |
| Misc. Expenses                  | 1        | ls   | \$ 20,000  | \$ 20,000           |
| <b>Grand Total</b>              |          |      |            | <b>\$ 3,656,391</b> |





Mountain View  
Whisman  
School District

# Schedule





Mountain View  
Whisman  
School District

# Thoughts and Questions