



Action Day | Primary Plus

INFANT CARE & PRESCHOOL

COOPER CAMPUS EXPANSION

CURRENT CAMPUS

- Action Day Primary Plus campus opened at Cooper site in 1981
- 9 Classrooms
- 25 Parking spaces
- Enrollment capacity of 160 students
- 30 Staff



PROPOSED CAMPUS

- Add 7 new modular preschool buildings and play area
- Increase enrollment to 260 students
- Increase staff to 45
- Increase parking capacity to 58 spaces
 - Add new parking lot
 - Expand existing parking lot

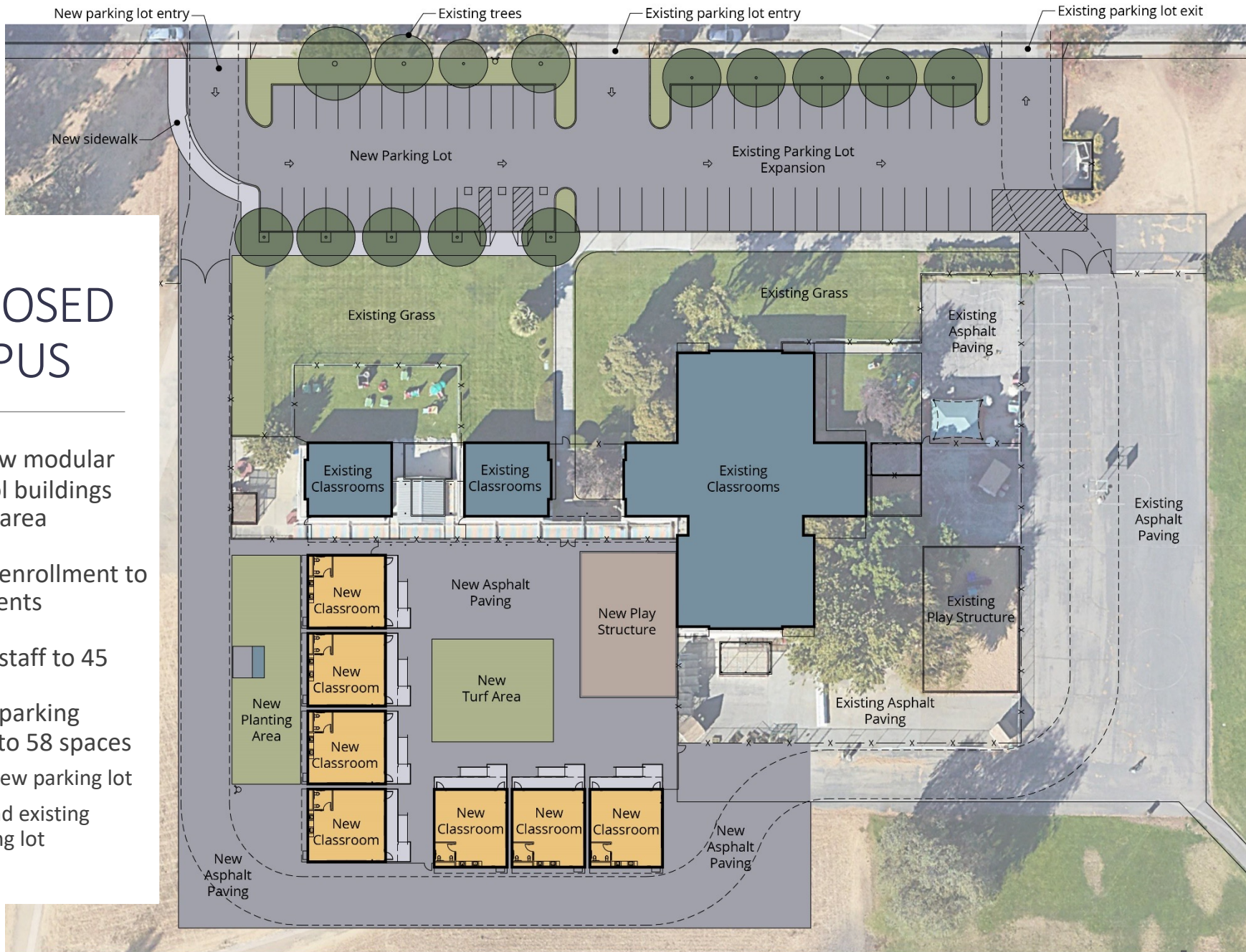

PROPOSED COMMUNITY OUTREACH

- Community Meeting to Review Proposed Plans
- Community Meeting Before Start of Construction
- Notification of Community Meeting(s)
 - Mail postcards to neighbors
 - Poster at site with meeting date and time
 - Notification to City of Mountain View
- Board of Trustees Updates



THOUGHTS & QUESTIONS