

# Mountain View Whisman School District Staff ROAD TO THE 2020 CENSUS

January 16, 2020

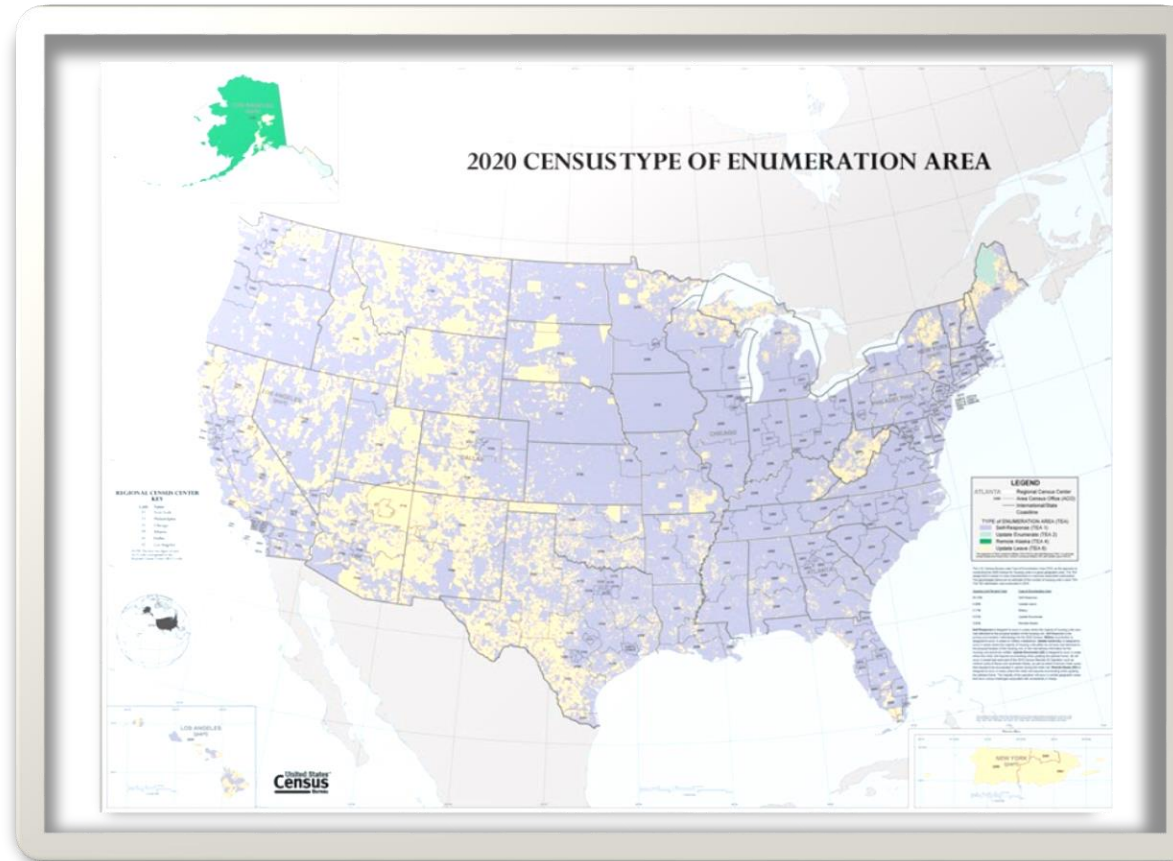

Presented by Ray Mueller, Partnership Specialist,  
U.S. Census Bureau, Los Angeles Region

2020CENSUS.GOV

Shape  
your future  
START HERE >

United States<sup>®</sup>  
Census  
2020

# Why Do We Take A Census?

## It's in the Constitution!

The United States Census (plural censuses or censi) is a decennial census mandated by Article I, Section 2 of the United States Constitution, which states: "Representatives and direct Taxes shall be apportioned among the several States... according to their respective Numbers... . The actual Enumeration shall be made within three years after the first meeting of the Congress of the United States, and within every subsequent Term of ten Years". ~ Wikipedia



Shape  
your future  
START HERE >

United States<sup>®</sup>  
Census  
2020

# How & When Will We Invite You to Respond?

## Mail, More Mail, In Person

When it's time to respond, most households will receive an invitation in the mail. Every household will have the option of responding online, by phone, or by mail.

Every household that hasn't responded will receive reminders and will eventually receive a paper questionnaire.

If you don't respond online, by phone, or by mail, we will follow up in person.

WHAT WE WILL SEND IN THE MAIL	
On or between	You'll receive:
March 12–20	An invitation to respond online to the 2020 Census. (Some households will also receive paper questionnaires.)
March 16–24	A reminder letter.
	<b>If you haven't responded yet:</b>
March 26–April 3	A reminder postcard.
April 8–16	A reminder letter and paper questionnaire.
April 20–27	A final reminder postcard before we follow up in person.

Shape  
your future  
START HERE >

United States<sup>®</sup>  
**Census**  
2020

# Letters, Postcards and Bilingual Questionnaires

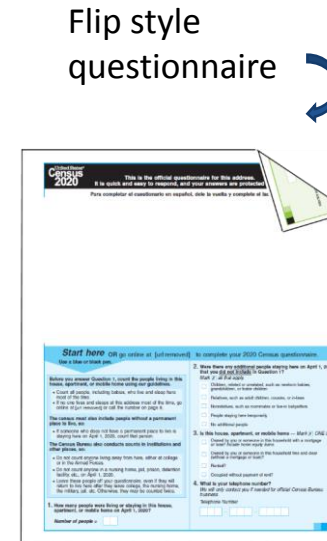
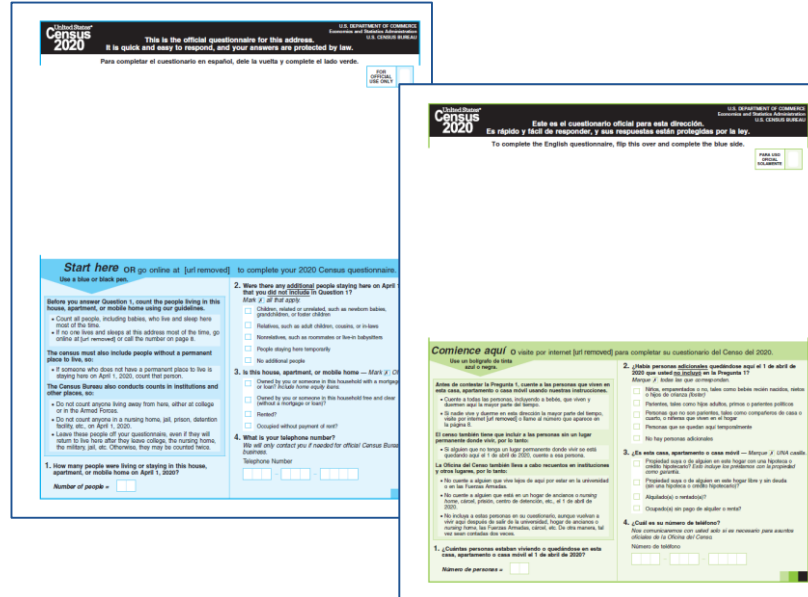
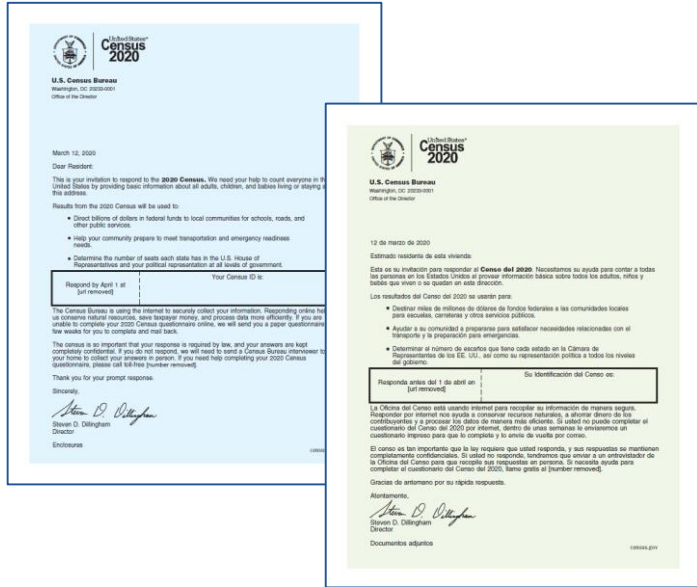

## Which one will go to whom?

Most households will first receive a letter asking them to complete the census questionnaire online with information about how to respond online or by phone in English plus 12 non-English languages.

[Press Release and Link to Interactive Map](#)



# Print Language Guides

Print language guides, written in 59 non-English languages, will assist respondents filling out the paper questionnaire.

Guides will also be available in large print and braille.

Each guide is 8 pages, and includes basic information about the 2020 Census and translation of the questions and response categories.

Print language guides will be available online and through FLD Partnerships.

**\*These print guides will include Braille and Large Print.**

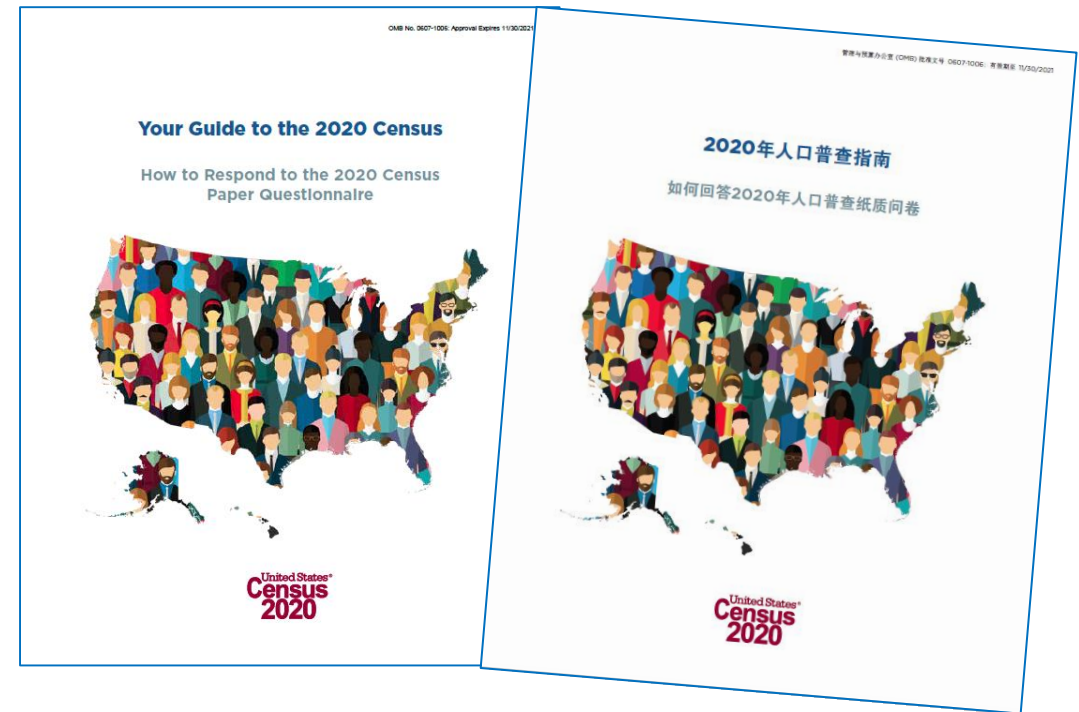

Shape  
your future  
START HERE >

United States<sup>®</sup>  
Census  
2020

# What if we don't read English?

Internet Self-Response	Census Questionnaire Assistance	Language Guides (Video and Print) Language Glossaries Language Identification Card	Paper Questionnaire & Mailing Materials																																																												
<p><b>12 Non-English Languages</b></p> <p>Respondents will be able to toggle between the languages within the instrument.</p> <p>Spanish Chinese Vietnamese Korean Russian Arabic Tagalog Polish French Haitian Creole Portuguese Japanese</p>	<p><b>12 Non-English Languages</b></p> <p>There is a separate phone number for each language, including TDD. This information is included in the mailing materials.</p> <p>Spanish Chinese (Mandarin and Cantonese) Vietnamese Korean Russian Arabic Tagalog Polish French Haitian Creole Portuguese Japanese</p>	<p><b>59 Non-English Languages</b></p> <p>Video and print language guides will be available online. Glossaries provide key terminology to bilingual staff. Language Identification Card expanded to 59 languages (50 in 2010). <i>Language listed below are in order of need (top to bottom, left to right).</i></p> <table border="0"> <tr> <td>Spanish</td> <td>Italian</td> <td>Khmer</td> <td>Tamil</td> <td>Croatian</td> </tr> <tr> <td>Chinese</td> <td>Farsi</td> <td>Nepali</td> <td>Navajo</td> <td>Bulgarian</td> </tr> <tr> <td>Vietnamese</td> <td>German</td> <td>Urdu</td> <td>Hungarian</td> <td>Twi</td> </tr> <tr> <td>Korean</td> <td>Armenian</td> <td>Romanian</td> <td>Hebrew</td> <td>Lithuanian</td> </tr> <tr> <td>Russian</td> <td>Hindi</td> <td>Telugu</td> <td>Malayalam</td> <td>Yoruba</td> </tr> <tr> <td>Arabic</td> <td>Ukrainian</td> <td>Burmese</td> <td>Swahili</td> <td>Czech</td> </tr> <tr> <td>Tagalog</td> <td>Bengali</td> <td>Punjabi</td> <td>Yiddish</td> <td>Igbo</td> </tr> <tr> <td>Polish</td> <td>Greek</td> <td>Lao</td> <td>Indonesian</td> <td>Marathi</td> </tr> <tr> <td>French</td> <td>Amharic</td> <td>Hmong</td> <td>Serbian</td> <td>Sinhala</td> </tr> <tr> <td>Haitian Creole</td> <td>Somali</td> <td>Albanian</td> <td>Tigrinya</td> <td>Slovak</td> </tr> <tr> <td>Portuguese</td> <td>Thai</td> <td>Turkish</td> <td>Ilocano</td> <td>American</td> </tr> <tr> <td>Japanese</td> <td>Gujarati</td> <td>Bosnian</td> <td>Dutch</td> <td>Sign Language</td> </tr> </table>	Spanish	Italian	Khmer	Tamil	Croatian	Chinese	Farsi	Nepali	Navajo	Bulgarian	Vietnamese	German	Urdu	Hungarian	Twi	Korean	Armenian	Romanian	Hebrew	Lithuanian	Russian	Hindi	Telugu	Malayalam	Yoruba	Arabic	Ukrainian	Burmese	Swahili	Czech	Tagalog	Bengali	Punjabi	Yiddish	Igbo	Polish	Greek	Lao	Indonesian	Marathi	French	Amharic	Hmong	Serbian	Sinhala	Haitian Creole	Somali	Albanian	Tigrinya	Slovak	Portuguese	Thai	Turkish	Ilocano	American	Japanese	Gujarati	Bosnian	Dutch	Sign Language	<p><b>Spanish</b></p> <p>Bilingual mailing materials and questionnaires will be sent to addresses in bilingual tracts.</p> <p>Mailings will include instructions on responding via Internet or phone in 12 non-English languages.</p> <p><b>During Nonresponse Followup enumerators use:</b></p> <ul style="list-style-type: none"> <li>• A bilingual handheld instrument (English/Spanish)</li> <li>• Bilingual materials (English/Spanish)</li> <li>• Instructions to respond online or by phone in 12 non-English languages</li> <li>• Language Identification Card</li> </ul>
Spanish	Italian	Khmer	Tamil	Croatian																																																											
Chinese	Farsi	Nepali	Navajo	Bulgarian																																																											
Vietnamese	German	Urdu	Hungarian	Twi																																																											
Korean	Armenian	Romanian	Hebrew	Lithuanian																																																											
Russian	Hindi	Telugu	Malayalam	Yoruba																																																											
Arabic	Ukrainian	Burmese	Swahili	Czech																																																											
Tagalog	Bengali	Punjabi	Yiddish	Igbo																																																											
Polish	Greek	Lao	Indonesian	Marathi																																																											
French	Amharic	Hmong	Serbian	Sinhala																																																											
Haitian Creole	Somali	Albanian	Tigrinya	Slovak																																																											
Portuguese	Thai	Turkish	Ilocano	American																																																											
Japanese	Gujarati	Bosnian	Dutch	Sign Language																																																											

# Language Assistance Sheet

All mailing packages include a language assistance sheet with instructions in the 12 non-English languages.

The instructions explain how to select languages online, and provide dedicated phone numbers for each non-English language.

United States®  
Census  
2020

OMB No. 0607-1008; Approval Expires 11/30/2021

English  
Go to [redacted] and select "ENGLISH," located in the upper-right corner of the window, to access your 2020 Census questionnaire in English.

Español (Spanish)  
Vaya a [redacted] y seleccione "ESPAÑOL," en la esquina superior derecha de la ventana, para acceder al cuestionario del Censo del 2020 en español.

中文 (Chinese)  
请访问网站 [redacted]，并选择位于窗口右上角的“中文(简体)”，以连接到您的中文版2020年人口普查问卷表。

Tiếng Việt (Vietnamese)  
Hãy vào trang mạng [redacted] và chọn "TIẾNG VIỆT" ở góc trên bên phải của cửa sổ để truy cập bản câu hỏi Thống Kê Dân Số 2020 bằng Tiếng Việt.

한국어 (Korean)  
2020년 센서스 인구조사 설문지를 한국어로 보시려면 인터넷 사이트 [redacted]로 가셔서 화면의 오른쪽 상단 코너에 있는 "한국어"를 선택해 주십시오.

Русский (Russian)  
Чтобы получить доступ к анкете переписи населения 2020 года на русском языке, зайдите на веб-сайт [redacted] и выберите «РУССКИЙ» в правом верхнем углу окна.

العربية (Arabic)  
تفضل بزيارة [redacted] وحدد "العربية"، الموجودة في الزاوية اليمنى العلوية من الشاشة، للوصول إلى استبيان التعداد السكاني الخاص بك لسنة 2020، اتمل على الرقم المجاني: [redacted].

Tagalog (Tagalog)  
Pumunta sa [redacted] at piliin ang "TAGALOG," na nasa itaas na kanang sulok ng window, upang ma-access ang iyong palatanungan ng 2020 Senso sa Tagalog.

Polski (Polish)  
Aby uzyskać dostęp do kwestionariusza Spisu Ludności 2020 w języku polskim, proszę przejść na stronę [redacted] i wybrać "POLSKI" w górnym prawym rogu ekranu.

Français (French)  
Rendez-vous sur [redacted] et sélectionnez « FRANÇAIS », situé dans le coin supérieur droit de la fenêtre, pour accéder à votre questionnaire du Recensement 2020 en français.

Kreyòl Ayisyen (Haitian Creole)  
Pou gen aksè sou kesyonè Resansman 2020 an, nan Kreyòl Ayisyen ale sou sitwèb [redacted] epi chwazi "KREYÒL AYISYEN," nan kwen anwo nan bò dwat fenèt la.

Português (Portuguese)  
Visite [redacted] e clique em "PORTUGUÊS" no canto superior direito da janela para acessar o questionário do Censo 2020 em português.

日本語 (Japanese)  
[redacted] にアクセスして、ウィンドウの右上角にある「日本語」を選択し、2020年国勢調査（日本語版）にアクセスしてください。

FORM D-LI (06-04-2019)

English  
For help completing your 2020 Census questionnaire, call toll-free [redacted].  
For telephone display service (TDD) for the hearing impaired, call toll-free [redacted].

Español (Spanish)  
Si necesita ayuda para completar el cuestionario del Censo del 2020, llame gratis al [redacted].

中文 (Chinese)  
如果您填写2020年人口普查问卷时需要帮助，请拨打免费电话：[redacted]（普通话）或 [redacted]（广东话）。

Tiếng Việt (Vietnamese)  
Để được trợ giúp hoàn thành bản câu hỏi Thống Kê Dân Số 2020 của quý vị, hãy gọi số miễn phí [redacted].

한국어 (Korean)  
2020년 센서스 인구조사 설문지 작성에 도움이 필요하시면, 무료 번호 [redacted]으로 전화해 주십시오.

Русский (Russian)  
Для помощи в заполнении анкеты переписи населения 2020 года, позвоните по номеру [redacted] (бесплатно).

العربية (Arabic)  
[redacted].

Tagalog (Tagalog)  
Para sa tulong sa pagkumpleto ng iyong palatanungan ng 2020 Senso, tumawag nang toll free sa [redacted].

Polski (Polish)  
Aby uzyskać pomoc w wypełnieniu kwestionariusza Spisu Ludności 2020, proszę zadzwonić pod bezpłatny numer [redacted].

Français (French)  
Pour obtenir une aide afin de remplir votre questionnaire du Recensement 2020, appelez gratuitement le [redacted].

Kreyòl Ayisyen (Haitian Creole)  
Pou jwenn èd ranpli kesyonè Resansman 2020 an, rele nimewo nou an gratis: [redacted].

Português (Portuguese)  
Para obter ajuda para responder ao questionário do Censo 2020, ligue gratuitamente para o telefone [redacted].

日本語 (Japanese)  
2020年国勢調査についてご不明な点があるときは、フリーダイヤル [redacted] までお電話ください。

FORM D-LI (06-04-2019)

# What Do You Do to Respond?

## New Ability to Self Respond Starting March 12, 2020



Internet\*



Phone\*



Paper Form



In-person

***\*12 languages plus English and TDD  
(Telecommunications Device for the Deaf) will be supported.***



# Internet Self-Response

The internet questionnaire will allow respondents to toggle between English and 12 non-English languages using a dropdown language menu at the top of each screen, and individual links at the top and bottom of each screen.

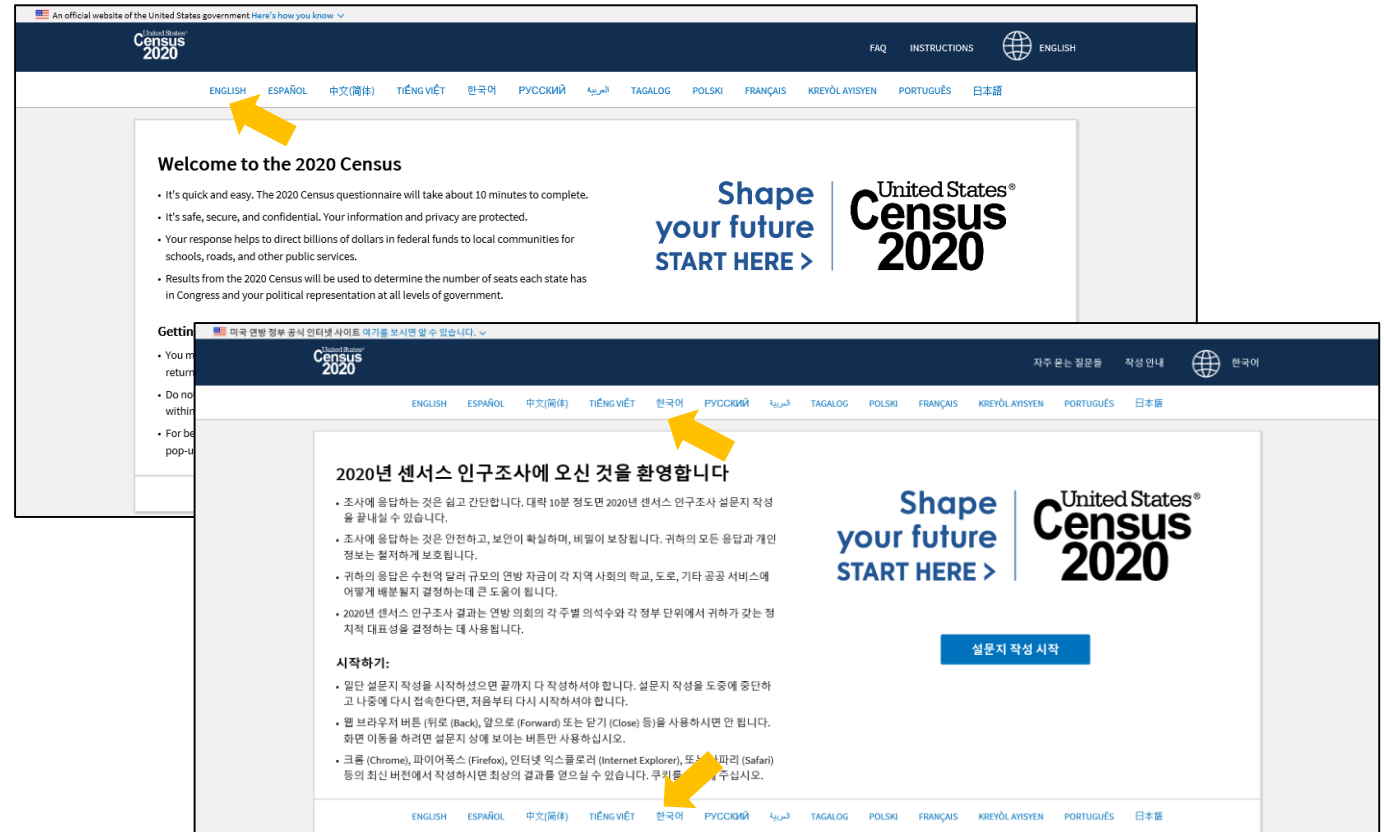

# Internet Self-Response (cont'd)

An official website of the United States government [Here's how you know](#)

**United States Census 2020**

FAQ INSTRUCTIONS  ENGLISH

ENGLISH ESPAÑOL 中文(简体) TIẾNG VIỆT 한국어 РУССКИЙ العربية TAGALOG POLSKI FRANÇAIS KREYÒL AYISYEN PORTUGUÊS 日本語

## Welcome to the 2020 Census

- It's quick and easy. The 2020 Census questionnaire will take about 10 minutes to complete.
- It's safe, secure, and confidential. Your information and privacy are protected.
- Your response helps to direct billions of dollars in federal funds to local communities for schools, roads, and other public services.
- Results from the 2020 Census will be used to determine the number of seats each state has in Congress and your political representation at all levels of government.

### Getting started:

- You must complete your questionnaire once you begin. If you leave the questionnaire and return later, you will have to start over.
- Do not use the web browser buttons (back, forward, or close browser). Use the buttons within the questionnaire to navigate.
- For best results, use the latest version of Chrome, Firefox, Internet Explorer, or Safari. Enable cookies.

**Shape your future START HERE >** | **United States Census 2020**

[Start Questionnaire](#)

ENGLISH ESPAÑOL 中文(简体) TIẾNG VIỆT 한국어 РУССКИЙ العربية TAGALOG POLSKI FRANÇAIS KREYÒL AYISYEN PORTUGUÊS 日本語

**\*\* U.S. Census Bureau Notice and Consent Warning \*\***

You are accessing a United States Government computer network. Any information you enter into this system is confidential. It may be used by the Census Bureau for statistical purposes and to improve the website. If you want to know more about the use of this system, and how your privacy is protected, visit our online privacy webpage at <https://www.census.gov/about/policies/privacy/privacy-policy.html>.

Use of this system indicates your consent to collection, monitoring, recording, and use of the information that you provide for any lawful government purpose. So that our website remains safe and available for its intended use, network traffic is monitored to identify unauthorized attempts to access, upload, change information, or otherwise cause damage to the web service. Use of the government computer network for unauthorized purposes is a violation of Federal law and can be punished with fines or imprisonment (PUBLIC LAW 99-474).

OMB No.: 0607-1006 | Approval Expires: 11/30/2021

# Internet Self-Response For Those Without Usual Residence

United States<sup>®</sup>  
**Census  
2020**

FAQ INSTRUCTIONS  ENGLISH

Address Verification Household Questions People Questions Final Questions

Please provide a city and state, or ZIP Code where you will be living on April 1, 2020.  
Also, describe the physical location in the space provided. [Help?](#)

City State ZIP Code

Please provide as much information as possible.

For example:

- a location description such as "The apartment over the gas station" or "The brick house with the screened porch on the northeast corner of Farm Road and HC 46" or
- a name of a park, street intersection or shelter, if you will be experiencing homelessness on April 1, 2020, as well as the name of the city and state. For example, "Friendship Park, Anywhere, PA."

Shape  
your future  
START HERE >

United States<sup>®</sup>  
**Census  
2020**

# Counting Young Children

1 million children were missed in the 2010 Census

- Children living in poverty
- Children with young parents
- Children living in complex living situations
  - Split households
  - Large households
  - Non-biological children: stepchildren, grandchildren, other relatives or unrelated children.
  - Newborn children



**If you have children in your home, make sure they are counted in the right place.**

Young children experience new adventures each day, and little ones need all of the support they can get during these early years.

- Count children in the home where they live and sleep most of the time, even if their parents don't live there.
- If a child's time is divided between more than one home, count them where they stay most often. If their time is evenly divided, or you don't know where they stay most often, count them where they are staying on Census Day—April 1, 2020.
- If a child's family (or guardian) is moving during March or April 2020, count them at the address where they are living on April 1, 2020.
- Count children in your home if they don't have a permanent place to live and are staying in your home on April 1, 2020, even if they are only staying with you temporarily.
- Count newborn babies at the home where they will live and sleep most of the time, even if they are still in the hospital on April 1, 2020.

**Start shaping their future by going to [2020CENSUS.GOV](https://2020CENSUS.GOV).**

Shape your future  
START HERE >

United States  
**Census  
2020**

Shape  
your future  
START HERE >

United States<sup>®</sup>  
**Census  
2020**

## What's New for 2020?

Our 2020 SIS materials will leverage Census data and hands-on activities to remind educators, parents, and students of the importance of 2020 Census completion. SIS will provide:

**A storybook** with activities for children in preschool and early grades.

**New activities** – making a total of more than 200 available!

**Engaging videos**

**Large, colorful maps** with fun census-based facts about the country and its territories, including state-by-state comparisons.

**Resources for English language learners** and adult students studying English as a second language



CENSUS.GOV/SCHOOLS

10

For Internal and Deliberative Use Only

Shape  
your future  
START HERE >

Shaping the Future  
Census  
2020



# Who Works for the Census?



JOB DETAILS

HOW TO APPLY

LOCATIONS

FAQS

APPLY NOW

Language Options:

English

## 2020 Census Jobs



[Access the 2020 Census Jobs Site](https://2020census.gov/jobs)

[2020census.gov/jobs](https://2020census.gov/jobs)

Shape  
your future  
START HERE >

United States<sup>®</sup>  
Census  
2020

**Census jobs available in all 8 San Francisco Bay Area Census Offices.  
One application qualifies you for any of the following positions:**

Position	Pay rate
Office Clerks	\$16 - \$27 per hour
Office Operations Supervisors	\$20.50 - \$33 per hour
Census Field Supervisors	\$22 - \$33 per hour
Enumerators (Census Takers)	\$20 - \$30 per hour
Recruiting Assistants	\$22 - \$33 per hour

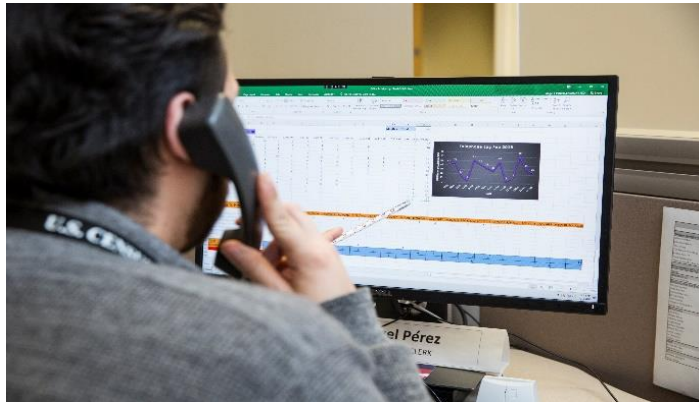

- ✓ Excellent Pay
- ✓ Flexible Hours
- ✓ Paid Training
- ✓ Temporary Positions

**Basic Requirements**

- 18 years of age or older
- Valid Social Security number
- U.S. Citizen
- Valid email address
- Must apply online

**Simple Application**

33 Question Assessment  
Plus 9 Supervisory questions  
if interested in Supervisory  
Positions

**Apply today!**

[2020census.gov/jobs](https://2020census.gov/jobs)

Federal Relay Service: (800) 877-8339 TTY / ASCII  
[www.gsa.gov/fedrelay](http://www.gsa.gov/fedrelay)

1-855-JOB-2020 (1-855-562-2020)

The U.S. Census Bureau is an Equal Opportunity Employer

Shape  
your future  
START HERE >

United States<sup>®</sup>  
**Census**  
**2020**

# Contact Information

## **RAYMOND MUELLER**

Partnership Specialist, San Francisco Bay Area

Team Leader, Santa Clara County

raymond.c.mueller@2020census.gov

818-983-2995

**Los Angeles Regional Census Center**

**UNITED STATES CENSUS BUREAU**

Search for:

[THE CENSUS SONG](#)

AND

[CENSUS - THIS IS ME](#)