

From:

November 9, 2018

Stuart Montrose  
Mont/Rose Moving Systems Inc.  
1810 Dobbin Dr. San Jose, CA 95133

Mountain View Whishman School District  
Attn: Robert Clark – Chief Business Officer  
1400 Montecito Ave  
Mountain View CA 94043

RE: Crittenden Library Book Move  
Huff and Landels Elementary School Library Move  
Bubb Elementary Library and Classroom Moves  
Mistral Kindergarten/Classroom Moves

Mont/Rose Moving Systems, Inc.  
1810 Dobbin Drive  
San Jose, CA 95133  
(408) 929-7100 FAX (408) 929-3740  
[www.mont-rose.com](http://www.mont-rose.com)



## Mountain View Whisman School District

**Mountain View Whisman School District**  
**Attn: Robert Clark – Chief Business Officer**  
**Address: 1400 Montecito Ave, Mountain View Ca 94043**

1. Library Books from Crittenden Middle School to Bubb, Huff and Landels Elementary.  
Move Date December 17<sup>th</sup> 2018

Starting address: 1701 Rock Street to the following addresses: Bubb ES 525 Hans Ave,  
Huff ES 253 Marten Ave, Landels ES 115 W. Dana Street all in Mountain View.

200-300 Library books boxed and ready to be moved to respective schools. All boxes labeled  
what school they are to go to. All boxes will go into the new library in a designated area. Box  
amount varies with site.

1 B/T & 1 Driver(s) For 8 Hours @ \$70.00 Per Hour Each	\$560.00
1 Working Supervisor(s) For 8 Hours @ \$47.50 Per Hour Each	380.00
2 Additional Mover(s) For 8 Hours @ \$42.50 Per Hour Each	680.00
Fuel Surcharge	<u>30.00</u>

**Total Estimated Cost                      \$1,650.00**



## Mountain View Whisman School District

**Mountain View Whisman School District**  
**Attn: Robert Clark – Chief Business Officer**  
**Address: 1400 Montecito Ave, Mountain View Ca 94043**

2. Entire Library Move Huff and Landels Elementary School. Move dates can be anywhere between Dec 22<sup>nd</sup> thru Dec 29<sup>th</sup>.

Move existing library for each site which is located onsite in a portable to the new library located in front of school. No shelving, cabinets or librarian desk will be moved. Boxes of books, supplies, rolling carts, tablets, chairs misc. items and other furniture will be moved. Computers and printers are to be moved. Direct move onsite to new library.

New library building is in front of each school next to administration building. Everything will be packed up, computers; printers etc. will be loose so please supply computer carts. All rugs go nothing to be taken off the walls. Items that will stay will be clearly marked.

621 W. Spain Street, Sonoma Ca 95476  
Phone: (707) 933-0624 Fax: (707) 996-8390  
[www.greystonewest.com](http://www.greystonewest.com)

1 Van & 1 Driver(s) For 16 Hours @ \$70.00 Per Hour Each	\$1,120.00
1 Working Supervisor(s) For 16 Hours @ \$47.50 Per Hour Each	760.00
6 Additional Mover(s) For 16 Hours @ \$42.50 Per Hour Each	4,080.00
Fuel Surcharge	<u>60.00</u>
<b>Total Estimated Cost</b>	<b>\$6,020.00</b>

Mont/Rose Moving Systems, Inc.  
1810 Dobbin Drive  
San Jose, CA 95133  
(408) 929-7100 FAX (408) 929-3740  
[www.mont-rose.com](http://www.mont-rose.com)



## Mountain View Whisman School District

**Mountain View Whisman School District**  
**Attn: Robert Clark – Chief Business Officer**  
**Address: 1400 Montecito Ave, Mountain View Ca 94043**

- ~~3. Entire Library Move and 2 Classroom Moves SDC # 1 & 2 Bubb Elementary School  
525 Hans Ave Mountain View Ca. Move dates can be anywhere between Dec 22<sup>nd</sup>  
thur Dec 29<sup>th</sup> .~~

~~Move existing library for each site which is located onsite in a portable to the new library located in front of school. No shelving, cabinets or librarian desk will be moved. Boxes of books, supplies, rolling carts, tablets, chairs, misc. items and other furniture will be moved. Computers and printers are to be moved. Direct move onsite to new library.~~

~~New library building is in front of each school next to administration building.  
Everything will be packed up, computers; printers etc. will be loose so please supply computer carts. All rugs go nothing to be taken off the walls. Items that will stay will be clearly marked. SDC rooms to be moved into new library rooms.~~

1 Van & 1 Driver(s) For 8 Hours @ \$70.00 Per Hour Each	\$560.00
2 Working Supervisor(s) For 8 Hours @ \$47.50 Per Hour Each	760.00
7 Additional Mover(s) For 8 Hours @ \$42.50 Per Hour Each	2,380.00
Fuel Surcharge	<u>30.00</u>

**Total Estimated Cost                      \$3,730.00**

## *Estimated Breakdown of Cost*

### Mountain View Whisman School District

**Mountain View Whisman School District**  
**Attn: Robert Clark – Chief Business Officer**  
**Address: 1400 Montecito Ave, Mountain View Ca 94043**

4. ~~3 Kindergarten Classrooms Moves and 1 Classroom – Gabriella Mistral Elementary School  
505 Escuela Ave, Mountain View Ca. Move dates can either be Dec 28<sup>th</sup> or Dec 29<sup>th</sup>~~

~~Onsite move of 3 Kindergarten classrooms to new location on site. Added -1 complete onsite classroom move. All items in all classrooms will be moved into their new location onsite.~~

<del>1 Van &amp; 1 Driver(s) For 8 Hours @ \$70.00 Per Hour Each</del>	<del>\$560.00</del>
<del>1 Working Supervisor(s) For 8 Hours @ \$47.50 Per Hour Each</del>	<del>380.00</del>
<del>3 Additional Mover(s) For 8 Hours @ \$42.50 Per Hour Each</del>	<del>1,020.00</del>
<del>Fuel Surcharge</del>	<del>30.00</del>

~~**Total Estimated Cost**                      **\$1,990.00**~~

**BARBARA**

M = MOVE

YMCA KIDS PLACE

MUR

PARKING

Bubb Elementary School  
525 Hans Ave.  
Mountain View, CA 94040  
650.526.3480

R 24  
Scott/  
McNally  
3rd

R 25  
Owens  
RSP

R 26 M  
Coyne  
3-5 SDC

R 27 M  
Library

R 28 M  
Chavez  
K-2 SDC

R 29  
Dux  
1st

R 23  
Carpenter  
3rd

R 22  
Willis  
3rd

R 30  
Ackermann  
3rd

R 17  
Hamor  
5th

R 18  
Galazzo  
5th

R 19  
Poling  
Science lab

R 20  
Arbildo  
5th

R 13  
Campion  
2nd

R 14  
Milos  
4th

R 15  
duMee  
4th

R 16  
Yuan  
4th

CANOPY

R 9  
Franklin  
2nd

R 10  
Shephard  
Science lab

R 11  
Ewings  
2nd

R 12  
Pasquini  
2nd

PLAYGROUND

PLAYGROUND

R 1 Bui kinder	R 2 Stout kinder	R 3 Kao kinder	R 4 Zimmerman kinder	R 5 Patterson K-1	R 6 Packer 1st	R 7 Orlovic 1st	R 8 West/ Gorospe 1st
----------------------	------------------------	----------------------	----------------------------	-------------------------	----------------------	-----------------------	--------------------------------

OFFICE

To Here Library  
soc soc

PARKING

PLAYGROUND

**HANS**



Rm	Cd	Staff Last Name	Rm	Gd	Staff Last Name
1	K	Lopez	19	K	Ramirez
2	K	Chesley	20	K	Montgomery
3	1	Reavis (Lowell)	21	-	YMCA
4	1	Garrison	22	3	Hinson
5	1	Wong	23	-	Carlingella/Van Tuyl
6	1	Bico	24	3	Ewing
7	1	Braunstein	25	3	Algren
8	2	McCullough	26	3	Luongo
9	2	Hamaguchi	27	-	Library - Kalb
10	2	Balmer	MUR	-	OT - Weller
11	2	Goble/Pardini	Ed Spc	-	Altun
12	4	Stern	SLP	-	Blair
13	4	Ngo	Office	-	Chang, Christensen
14	4	Mello			Barron, Diaz, Gillson, CHAC
15	3/4	Hsieh			
16	5	Schaefer			
17	5	Martinka			
18	5	Libuit			

**M = MOVES**

Back Entrance #1:  
Carol Gate

Back Entrance #2:  
Woodleaf Gate

Field

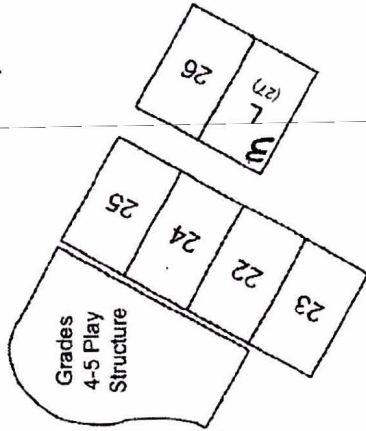
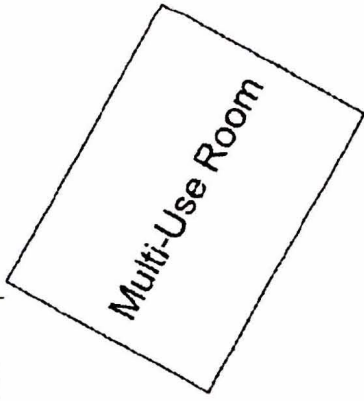

Field

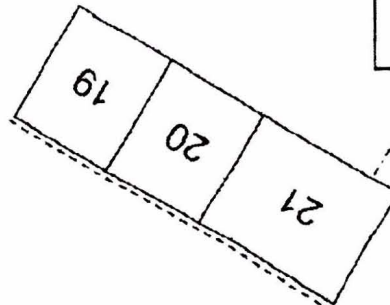
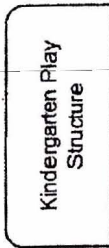
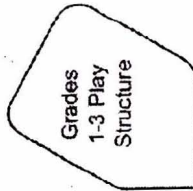

Blacktop

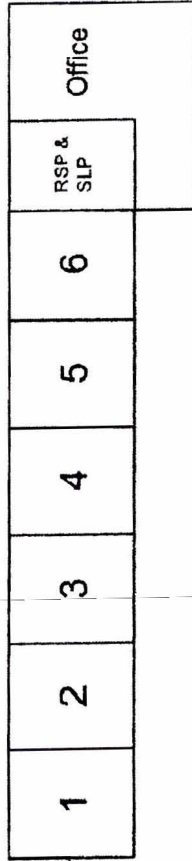
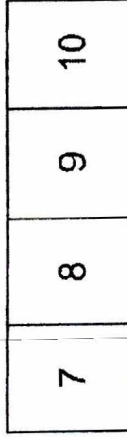
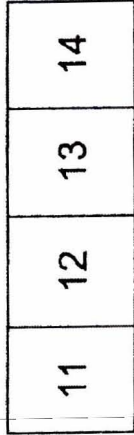
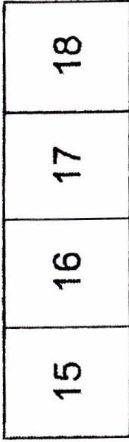

Staff Parking Only

Side Entrance:  
open during  
drop off and  
pickup only

Martens Avenue

Main Entrance



**Frank L. Huff  
Elementary  
School**  
map not drawn  
to scale  
253 Martens Avenue  
Mountain View, CA 94040  
Mountain View Whisman  
School District

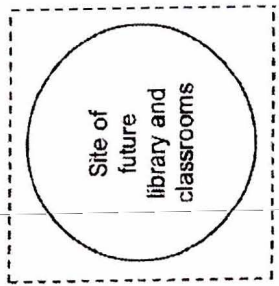

Staff Parking Only

from Martens Ave

to Grant Road

# Landels Classroom Assignments 2018-2019

K-5...Manabanag, Lot	1
K...Milos, Karen	2
K...Spence, Jennie	3
K...Timmins, Jennife	4
K...Castro, Monique	5
1...Risano, Ylva	6
1...Chung, Amanda	7
1...Vertemara, Valentina	11
1...Goldberg, Jessica	12
2...Nicolino, Kathy	13
2...DeRitis, Paula	25
2...Miller, Leah	26
2...Stevenson, Michelle	27
3...Vogel, Audrey	28
3...Parry, Liz	22
3...Haley, Klancey	23
3...Sellers, Christina	24
4...Wester, Evelyn	29
4...Allan, Pat	14
5...Bassett, Shamai/ Lee, Gail	15
5...Poor, Margaret	16
5...Hanneman, Anne	17
ELD... Antonakopoulous, Christine	9
RTI... Levy, Judy/ Karzian, Lela	10
Library...Jennings, Anne	30
Resource...Decker, Hope	31
Psychologist...Im-Wang, Sunny	
Speech...Lieu, Jo-Ann	
Instructional Coach... Gordon, Karen	
At Risk Supervisor...Terlep, Henry	

Sellers Grade 3 Room 29
Vogel Grade 3 Room 22
Parry Grade 3 Room 23
Haley Grade 3 Room 24
Nicolino Grade 2 Room 25
DeRitis Grade 2 Room 26
Miller Grade 2 Room 27
Stevenson Grade 2 Room 28

Jennings  
Library  
**m**  
Room 30

Decker  
Resource  
Room 31

MUR

*m = move*

Bassett/ Lee Grade 5 Room 15	Poor Grade 5 Room 16	Hanneman Grade 5 Room 17	Allan Grade 4 Room 18
---------------------------------------	----------------------------	--------------------------------	-----------------------------

Chung Grade 1 Room 11	Vertemara Grade 1 Room 12	Goldberg Grade 1 Room 13	Wester Grade 4 Room 14
-----------------------------	---------------------------------	--------------------------------	------------------------------

Risano Grade 1 Room 7	Room 8	ELD Room 9	RTI Room 10
-----------------------------	--------	---------------	----------------

Room 1	Managanbag Grades K-5 Room 2	Milos Kinder Room 3	Spence Kinder Room 4	Timmins Kinder Room 5	Castro Kinder Room 6	Office
--------	------------------------------------	---------------------------	----------------------------	-----------------------------	----------------------------	--------

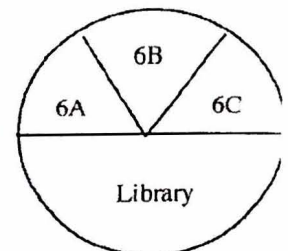



Mistral

